



# Minnesota e-Health Summit 2010

June 16-17, 2010

The Northland Inn, Brooklyn Park

## Summit Program and Exhibit Guide

### Leveraging Meaningful Use

Thursday, June 17, 2010 8:30 a.m. - 4:45 p.m.

### Two Pre-Summit Workshops

Wednesday, June 16, 2010 1:00 - 5:00 p.m.

*Reaching EHR Meaningful Use – Tap into the HIT Regional Extension Center*

*Minnesota TIGER Summit: Working Together, We Can Do It*

*Thank you to the following sponsors for their support!*

GOLD SPONSOR



SILVER SPONSOR



BRONZE SPONSOR



BRONZE SPONSOR



BRONZE SPONSOR



BRONZE SPONSOR



BRONZE SPONSOR



presented by:



Minnesota e-Health Advisory Committee

# *Welcome!*

The goal of the annual Minnesota e-Health Summit is to provide quality education about emerging national and state e-Health initiatives. This year's event is designed to provide participants with tools and resources to guide success in implementing EHRs and HIT in the current economic climate.

Keynoter Dr. David Blumenthal, National Coordinator for Health Information Technology, will give us the latest information on the national effort for adoption and meaningful use of health IT. Other highlights include two special Pre-Summit Workshops, a Showcase of leading community efforts, breakout sessions that highlight Minnesota projects and successes, and exhibits offering a range of products and services.

We are delighted that record numbers of participants are gathering here at the Northland Inn to help advance Minnesota's effort to meet the mandate to achieve interoperable EHRs by 2015 and optimize incentives from federal recovery act opportunities.

## *Table of Contents*

<b>General Information</b> .....	<b>1</b>
<b>Professional Education Credits</b> .....	<b>1</b>
<b>Summit Agenda</b> .....	<b>2</b>
<b>Pre-Summit Workshop Agendas:</b>	
<b>MN TIGER Summit</b> .....	<b>3</b>
<b>REACHing EHR Meaningful Use</b> .....	<b>4</b>
<b>Breakout Session Descriptions</b> .....	<b>5</b>
<b>Plenary Session Speaker Profiles</b> .....	<b>6</b>
<b>HITECH Resources Panel Members</b> .....	<b>7</b>
<b>Project Showcase Descriptions</b> .....	<b>8-11</b>
<b>Industry Expo Map</b> .....	<b>12</b>
<b>Industry Expo Guide</b> .....	<b>13-18</b>
<b>Summit Planning Committee</b> .....	<b>18</b>
<b>Minnesota e-Health Advisory Committee</b> .....	<b>19</b>
<b>Northland Inn Map</b> .....	<b>back cover</b>



# Minnesota e-Health Summit 2010

## General Information

### Summit Objectives

Upon completion of this program, each participant will be able to:

1. Describe how e-Health can be advanced through federal recovery act opportunities.
2. Discuss how the ARRA can support the successful utilization of an electronic health record.
3. Describe examples of value attained from electronic health records.
4. List three e-Health activities occurring in Minnesota.

### Important Times:

#### Registration/Information Desk

Wednesday: 11:00 AM - 5:00 PM

Thursday: 7:15 AM - 4:45 PM

#### Project Showcase and Industry Expo

Wednesday: 5:00 - 7:00 PM

Thursday: 7:15 AM - 3:15 PM

### Important Notes:

- No smoking is permitted in hotel meeting rooms and public areas.
- Please mute cell phones during summit sessions.
- Please indicate if you have any special needs and how we can accommodate those needs.

### Summit Evaluation

An online evaluation of the Summit will be sent to all participant emails on Thursday, June 17. Your input will provide valuable information to the planning committee so that next year's event is as timely and relevant as possible. We hope you will make it a priority to respond. Thank you.

### USB Drive

Each participant will receive a lanyard with an attached USB drive that contains the following:

- Summit Final Program
- Pre-Summit and Summit PowerPoint Presentations
- Faculty Biographical Information and Faculty Disclosures
- Minnesota e-Health Resources (Information and Web Links)
- Information on Federally Funded Programs in Minnesota
- Newly Updated Standards Guide

NOTE: Items not located on the USB drive may be downloaded by visiting [www.health.state.mn.us/e-health](http://www.health.state.mn.us/e-health)

## Professional Education Credits

**Accreditation Status:** This activity has been planned and implemented in accordance with the Essential Areas and Policies of the Minnesota Medical Association (MMA) through the joint sponsorship of Stratis Health and the Minnesota e-Health Initiative. Stratis Health is accredited by the MMA to provide continuing medical education for physicians.

**Physicians:** Stratis Health designates the Pre-Summit Workshop for a maximum of 3.75 *AMA PRA Category 1 Credits™* and the Summit for 6.0 *AMA PRA Category 1 Credits™*. Physicians should only claim credit commensurate with the extent of their participation in the activity.

**Nurses:** The MN Nursing TIGER Collaborative Pre-Summit Workshop is designed to meet Minnesota Board of Nursing criteria for continuing education required for licensure renewal, providing 4.1 contact hours.

The University of Minnesota School of Nursing, Office of Practice, Business and Professional Development is accredited as a provider of Continuing Nursing Education by the American Nurses Credentialing Center's Commission on Accreditation. The MN Nursing TIGER Collaborative Pre-Summit Workshop is awarded 3.40 contact hours.

The REACH Pre-Summit Workshop is designed to meet Minnesota Board of Nursing criteria for continuing education required for licensure renewal. It is the responsibility of the individual nurse to determine if the course fulfills that requirement. This program has been awarded for 4.2 contact hours. Please retain your certificate to verify your attendance. This program expires on: June 16, 2012.

The MN e-Health Summit is designed to meet Minnesota Board of Nursing criteria for continuing education required for licensure renewal. It is the responsibility of the individual nurse to determine if the course fulfills that requirement. This program has been awarded for 7.2 contact hours. Please retain your certificate to verify your attendance. This program expires on: June 17, 2012.

**Nursing Home Administrators:** The Minnesota Board of Examiners for Nursing Home Administrators has approved this program for 9.75 continuing education hours. This approval is effective through April 30, 2011. CE approval #: MN 11-013.

**Pharmacists:** Application has been made to the Minnesota Board of Pharmacy for continuing education approval.

# Agenda — Wednesday, June 16

11:00 AM – 1:00 PM	<b>Registration</b>	<i>Ballroom Concourse</i>
11:00 AM – 1:00 PM	Lunch <i>(included with registration)</i>	<i>America's Harvest Restaurant</i>
1:00 – 5:00 PM	<b>Pre-Summit Workshop</b> <i>(see page 3 for complete agenda)</i> "Minnesota TIGER Summit: Working Together, We Can Do It"	<i>Northland West</i>
1:00 – 5:00 PM	<b>Pre-Summit Workshop</b> <i>(see page 4 for complete agenda)</i> "Reaching EHR Meaningful Use – Tap into the HIT Regional Extension Center"	<i>Northland East</i>
5:00 – 7:00 PM	<b>Industry Expo / Reception</b> Meet with industry representatives to explore the products and resources available to aid in implementing a health information technology strategy.	<i>Ballroom Concourse</i>
	<b>Project Showcase</b> Learn first hand about real Minnesota projects in an interactive setting!	<i>Minnesota North</i>

# Agenda — Thursday, June 17

7:15 – 8:30 AM	Registration/Continental Breakfast	<i>Ballroom Concourse</i>
7:15 AM - 3:15 PM	Project Showcase Industry Expo	<i>Minnesota North</i> <i>Ballroom Concourse</i>
8:30 – 8:45 AM	<b>Welcome and Opening Remarks</b> Martin LaVenture, PhD, MPH, Director, Office of Health Information Technology, Minnesota Department of Health Sanne Magnan, MD, PhD, Commissioner, Minnesota Department of Health	<i>Northland Ballroom</i>
8:45 – 9:45 AM	<b>Keynote:</b> "Perspectives from the National Coordinator" David Blumenthal, MD, MPP, National Coordinator for Health Information Technology	<i>Northland Ballroom</i>
9:45 – 10:15 AM	<b>Minnesota e-Health: Leveraging Meaningful Use</b> MN e-Health Advisory Committee Co-Chairs: Jennifer P. Lundblad, PhD, MBA, President and Chief Executive Officer, Stratis Health Walter Cooney, JD, MA, Executive Director, Neighborhood Healthcare Network	<i>Northland Ballroom</i>
10:15 – 10:45 AM	Break/Project Showcase/Industry Expo	<i>Minnesota North &amp; Ballroom Concourse</i>
10:45 – 12:00 PM	<b>Successfully Leveraging HITECH Resources</b> Panel of Federally Funded Projects to Support Minnesota Activities Moderator: Alan Abramson, PhD, Sr. Vice President, Info. Services & Chief Info. Officer, HealthPartners Bob Paulsen, CMS Meaningful Use Incentives, Minnesota Department of Human Services (Incentives) Paul Kleeberg, MD, Regional Extension and Assistance Center for HIT, Key Health Alliance (REACH) Julie Jacko, PhD, HIT University Partnership for Health Informatics, University of Minnesota (Workforce) Jim Golden, PhD, Minnesota e-Health Connect, Minnesota Department of Health (Exchange) Christopher G. Chute, MD, DrPH, Mayo Clinic (SHARP Research and Beacon Community Collaborative)	<i>Northland Ballroom</i>
12:00 – 1:15 PM	Lunch <i>(included with registration)</i>	<i>America's Harvest Restaurant</i>
1:15 – 2:45 PM	<b>Breakout Sessions 1-4</b> <i>(see details on page 5)</i> 1. REACHing for Meaningful Use 2. Leveraging HIT for Success in MN's Health Reform Initiative 3. Connecting for Meaningful Use: "Live" Demonstrations from MN Health Information Orgs. 4. Explore Privacy-Security Policy for Electronic Health Records through Examples and Case Studies	<i>Longfellow's</i> <i>Northland East</i> <i>Northland West</i> <i>Minnesota South</i>
2:45 – 3:15 PM	Break/Project Showcase/Industry Expo	<i>Minnesota North &amp; Ballroom Concourse</i>
3:15 – 4:45 PM	<b>Breakout Sessions 5-8</b> <i>(see details on page 5)</i> 5. Meaningful Use and Beyond 6. Mobilizing the HIT Workforce through Education and Training 7. Lessons in Planning and Implementation of Exchange of Health Information 8. Building Capacity in Your Community: Lessons from Beacon Applications	<i>Longfellow's</i> <i>Northland East</i> <i>Northland West</i> <i>Minnesota South</i>
4:45 PM	Adjourn	

# Agenda — Wednesday, June 16 — 1:00-5:00

## Minnesota TIGER Summit: Working Together, We Can Do It



UNIVERSITY OF MINNESOTA

School of Nursing  
Driven to Discover™

Minnesota TIGER Summit is designed to translate the vision of the national TIGER initiative into action in the upper-Midwest.

**The Purpose of this Summit is to:** Establish the foundation for a state-wide benchmarking project.

**Overall Objectives:** On completion of the program, the Nurse Leader will:

1. Compare documentation systems across settings
2. Disseminate best practice information, techniques and lessons learned

**Objective during the presentations:** Minnesota nurse leaders will describe the use of specific informatic documentation systems used in diverse nursing practices.

1:00 - 1:15 PM

### Welcome and Overview of the Summit

Bonnie Westra

### Electronic Health Records - Targeted Topic: Prevention of Pressure Ulcers

1:15 - 1:35

#### Acute Care - Adult – Allina Health Care Systems

Presenters: Beverly Collins and Sue Sendelbach

1:35 - 1:55

#### Acute Care - Pediatrics – Gillette Children's Hospital

Presenter: JoAnn Pesek and Lynn Choromanski

1:55 - 2:25

#### Facilitated discussion of similarities and differences with other acute care settings

Moderator: Bonnie Westra

Panel: Mari Akre, Tari Rajchel, and Megan Daman

2:25 - 2:45

Break

2:45 - 3:05

#### Nursing home - Winona Manor

Presenter: Mary Miller-Hyland

3:05 - 3:25

#### Homecare - Guardian Angels Elim Home Care

Presenter: Barbara Burandt

3:25 - 3:55

#### Facilitated Discussion – similarities and differences with NH and HC experience

Moderator: LuAnne McNichols

Panel: Cheryl Krause and Linda Shell

### Public Health Panel - Targeted Topic: Meaningful Use of Nursing Data

3:55 - 4:25

#### Public Health Panel

Moderator: Karen A. Monsen

Panel: Jill Timm, Katie Halder, and Diane Thorson

4:25 - 5:00

#### Wrap Up - Next Steps

Bonnie Westra

5:00

Adjourn

### Presenter Credentials

Mari Akre, PhD, RN, Children's Hospital

Barbara Burandt, JD, RN, Guardian Angel Elim Home Care

Lynn Choromanski, MS, RN, Nursing Informatics Specialist, Gillette Children's Hospital

Beverly Collins, RN, BA - PhD candidate, Clinical Decision Support Lead, Allina Hospitals & Clinics

Megan Daman, MAN, RN, ACNS-BC, OCN, Nurse Manager, University of MN Medical Center, Fairview

Katie Halder MS, RN, PHN, Douglas County Public Center

Cheryl Krause, BSN, RN, Director of Nursing, Emanuel Nursing Home

LuAnne McNichols, MN, RN, PHN, Public Health Nursing Director, MDH/Office of Public Health Practice

Karen A. Monsen, PhD, RN, Assistant Professor, University of Minnesota School of Nursing

JoAnn Pesek, RN, Nurse Manager, Gillette Children's Specialty Healthcare

Tari Rajchel, MSN, RN, Nursing Informatics Specialist, Hennepin County Medical Center

Mary Miller-Hyland, RN, BA, Winona Senior Services Administrator, Winona Manor

Jill Timm, JD, RN, PHN, Program Manager, Maternal Child Health, Washington County Department of Public Health & Environment

Sue Sendelbach, PhD, RN, Clinical Nurse Specialist/Researcher, Allina Hospitals & Clinics

Linda M. Shell MA, BSN, RN, PHN, Director of Education and Learning, Volunteers of America

Diane Thorson MS, RN, PHN, Director/CHS Administrator, Otter Tail County Public Health

Bonnie Westra, PhD, RN, FAAN, Assistant Professor & Co-Director ICNP R&D Center, University of Minnesota, School of Nursing



## REACHing EHR Meaningful Use — Tap into the HIT Regional Extension Center

### Objectives

As a result of this workshop, participants will be able to:

1. Utilize REACH services in EHR selection, implementation, and meaningful use.
2. Describe and integrate the experiences of health care organizations that have successfully selected, implemented, and/or are on their way to achieving meaningful use of EHR.
3. Discuss and describe proven strategies, tools, and learning modalities to build skills needed to sustain meaningful use of EHR technology.

**Session Moderator:** Shirley Eichenwald-Maki, MBA, RHIA, FAHIMA, Associate Professor, Healthcare Informatics and Information Management, The College of St. Scholastica

1:00 – 1:05 PM	<b>Welcome</b> Jennifer Lundblad, PhD, MBA, President and CEO, Stratis Health
1:05 – 1:25	<b>Introduction to REACH</b> Sue Severson, Director of Health IT Services, Stratis Health
1:25- 1:55	<b>Overview: Meaningful Use / Incentives / Quality</b> Paul Kleeberg, MD, FAAFP, FHIMSS, REACH Clinical Director, Stratis Health
1:55 - 2:15	<b>REACH Methodology</b> Phil Deering, REACH Regional Coordinator, Stratis Health
2:15 - 2:30	Break
2:30 - 2:55	<b>Introduction to Case Studies</b> Margret Amatayakul, RHIA, CHPS, CPHIT, CPEHR, FHIMSS, President, MargretVA Consulting, LLC
	<b>Case Study – EHR Selection</b> James Dungan-Seaver, IT Manager, Hamm Clinic Elizabeth Ahl, EHR Project Coordinator, Hamm Clinic
2:55 - 3:20	<b>Case Study – EHR Implementation</b> Lois Mathews, EHR Project Manager, Hutchinson Medical Center
3:20 – 3:35	<b>Case Studies – EHR Optimization</b> Mark Roisen, Executive Director, Lac qui Parle Health Network
3:35 – 3:45	Break
3:45 - 4:15	<b>REACH Services and Pricing</b> Sally Buck, MS, Associate Director, National Rural Health Resource Center Julie Carlson, REACH Field Service Manager, Stratis Health Bill Sonterre, REACH Regional Coordinator, Stratis Health
4:15 - 4:30	<b>Next Steps</b> Sue Severson
4:30 - 5:00	<b>Questions/Discussion</b> Moderator: Shirley Eichenwald-Maki

# Breakout Session Descriptions

Thursday — 1:15-2:45 PM

## 1 REACHing for Meaningful Use

Moderator: Sally Buck, Associate Director, National Rural Health Resource Center

Katie Kerr, IT Manager, Kanabec Hospital

A Michael Shrift, MD, MBA, CMIO and VP Clinic Knowledge Management,

D Allina Hospitals and Clinics

O Craig Stevens, PhD, LP, Director of Clinical Services, Range Mental  
P Health Center

T Understand who is eligible and how to sign up for the REACH program. Hear case studies from different settings on how to get started and the culture change it entails. Understand the requirements for *Meaningful Use*.

## 2 Leveraging HIT for Success in MN's Health Reform Initiative

Moderator: Jennifer Lundblad, PhD, MBA, President and CEO, Stratis Health

U Carol Backstrom, Assistant to the Commissioner for Health Reform, MN  
T Department of Health

L Jeanine Rosner, RN, Manager, Primary Care/Health Care Homes, Park  
I Nicollet

Z Allie Coronis, Data Analyst, Quality and Safety Resources, Allina  
E Hospitals and Clinics

Jill Walters, Coordinator, Statewide Health Improvement Program,  
Olmsted County Public Health

Learn how technology, including EHRs, can be an effective tool to successfully meet Minnesota's health reform opportunities and requirements (e.g., health care homes, submitting data to the quality measurement system, participating in the Statewide Health Improvement Program).

## 3 Connecting for Meaningful Use: "Live" Demonstrations from MN Health Information Organizations

Moderator: Bobbie McAdam, Director, Business Integration and Portfolio Management, Medica

E Bobbie McAdam Director, Business Integration and Portfolio

C Management, Medica

H Michael Ubl, Executive Director, Minnesota Health Information Exchange  
A (MN HIE)

N Cheryl Stephens, PhD, MBA, President and CEO, Community Health  
G Information Collaborative (CHIC)

E Learn about Health Information Organizations (HIOs) in Minnesota and the services they offer to facilitate meaningful use. Understand how standards and exchange of information will meet meaningful use and help in accessing incentives.

## 4 Explore Privacy-Security Policy for Electronic Health Records through Examples and Case Studies

Moderator: Laurie Beyer-Kropuenske, Director of Information Policy Analysis, MN Department of Administration

E Patricia Carter, JD, Senior Counsel, HealthPartners

N Lois Dahl, MBA, Director of Information Privacy, Fairview Health Services

G David Lawton, Project Officer for the Midwest, Office of the National  
A Coordinator

G Learn about the potential effects of the HITECH Act including  
E breach notification, business associate agreements, and new rules and guidance. Discuss implications of the current privacy environment through case studies and examples.

Thursday — 3:15-4:45 PM

## 5 Meaningful Use and Beyond

Moderator: Paul Kleeberg, MD, REACH Clinical Director, Stratis Health

Barry Bershaw, MD, VP Quality and Interim Executive Regional

Medical Director, North Region Fairview Health System

A Paul Kleeberg, MD, REACH Clinical Director, Stratis Health

D See how EHR's can be leveraged to achieve requirements for  
O meaningful use using tools such as decision support, quality  
P reporting, reports for public health and information extraction  
T from electronic health records — all to improve the quality, efficiency and safety of care delivery.

## 6 Mobilizing the HIT Workforce through Education and Training

Moderator: Becky Schierman, Manager, Quality Improvement, Minnesota Medical Association

U Marty Witrak, PhD, RN, FAAN, Professor and Dean, School of Nursing,  
T The College of St. Scholastica

L Julie Jacko, PhD, Professor, Public Health and Nursing, University of  
I Minnesota

Z Sunny Ainley, Program Director, Normandale Community College

E Discuss current workforce challenges and discover training opportunities through university and community college programs to develop workforce competencies in Minnesota.

## 7 Lessons in Planning and Implementation of Exchange of Health Information

Moderator: Mark Sonneborn, Vice President Information Services,  
E Minnesota Hospital Association

Sandy Tubbs, Director, Douglas County Public Health

X Karen E. White, MPH, Epidemiologist/ Business Analyst, MIIC,

C Minnesota Department of Health

H Emily Peterson, BS, MIIC Director, Minnesota Department of Health

A Gary Wingrove, Director of Government Relations and Strategic

N Affairs, Mayo Clinic Medical Transport

E Discuss opportunities and challenges related to electronic exchange of health information with health and health care organizations across the continuum of care.

## 8 Building Capacity in Your Community: Lessons from Beacon Applications

Moderator: Christopher G. Chute, MD, DrPH, BioMedical Informatics,  
E Mayo Clinic

N John Sakowski, Chief Operating Officer, Institute for Clinical Systems  
G Improvement (ICSI)

A Mary Wellik, MPH, BSN, Director of Public Health, Olmsted County

G Charles Sawyer, DC, Senior Vice President, Northwestern Health  
E Sciences University

Charles Ness, President & CEO, Minnesota Rural Health Cooperative

Learn about exciting collaboration projects in communities. Understand how to build effective coalitions to achieve measurable improvements in health care quality and population health through plans for strengthening HIT infrastructure and exchange capabilities.

# Plenary Session Speakers

## Welcome and Opening Remarks

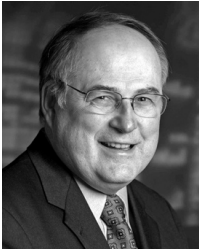

### **Martin LaVenture, PhD, MPH, Director, Office of Health Information Technology and e-Health, Minnesota Department of Health**

Marty LaVenture is currently leading the statewide e-Health Initiative. In addition, he is Principal Investigator for Grants from the Robert Wood Johnson Foundation and US Department of Health and Human Services. In 2008 he was named as one of the top 100 Influential Health-care Leaders in Minnesota.

Nationally, Dr. LaVenture serves on the editorial board for the Journal of Biomedical Informatics. He is Chair of the CDC Board of Scientific Counselors for Public Health Informatics and a member of the Public Health Davies Award Committee of the Health Information Management Systems Society (HIMSS). Dr. LaVenture has authored or co-authored many articles and scientific publications, delivered numerous presentations to state and national audiences, and received multiple awards for his work and accomplishments.



### **Sanne Magnan, MD, PhD, Commissioner, Minnesota Department of Health**

Dr. Sanne Magnan was appointed Minnesota Commissioner of Health in September 2007. She is also a staff physician at the Tuberculosis Clinic at St. Paul-Ramsey County Department of Public Health and a clinical assistant professor of medicine at the University of Minnesota. Prior to being appointed commissioner, Magnan served as president of the Institute for Clinical Systems Improvement (ICSI) in Bloomington and was vice president and medical director of Blue Cross Blue Shield of Minnesota. Magnan holds a medical degree and a doctorate in medicinal chemistry from the University of Minnesota and is a board certified general internist. Magnan was named one of the 100 Influential Health Care Leaders by Minnesota Physician in 2004 and 2008.

## Perspectives from the National Coordinator



### **David Blumenthal, MD, MPP, National Coordinator for Health Information Technology**

David Blumenthal was appointed as National Coordinator by President Obama in 2009. In this role he is charged with building an interoperable, private and secure nationwide health information system and supporting the widespread, meaningful use of health IT.

Dr. Blumenthal received his undergraduate, medical, and public policy degrees from Harvard University and completed his residency in internal medicine at Massachusetts General Hospital. Prior to his appointment to the administration, Dr. Blumenthal was a practicing primary care physician; director, Institute for Health Policy; and the Samuel O. Thier Professor of Medicine and Professor of Health Policy at the Massachusetts General Hospital/Partners HealthCare System and Harvard Medical School.

Dr. Blumenthal is a renowned health services researcher and national authority on health IT adoption. With his colleagues from Harvard Medical School, he authored the seminal studies on the adoption and use of health information technology in the United States.

A member of the Institute of Medicine and a former board member and national correspondent for the New England Journal of Medicine, Dr. Blumenthal has held several leadership positions in medicine, government, and academia including Senior Vice President at Boston's Brigham and Women's Hospital; Executive Director of the Center for Health Policy and Management and Lecturer on Public Policy at the Kennedy School of Government; and as a professional staff member on Senator Edward Kennedy's Senate Subcommittee on Health and Scientific Research.

## Minnesota e-Health: Leveraging Meaningful Use



### **Jennifer P. Lundblad, PhD, MBA, President and CEO, Stratis Health; MN e-Health Advisory Committee Co-Chair**

Jennifer leads Stratis Health, an independent non-profit quality improvement organization based in Bloomington, Minnesota, that leads collaboration and innovation in health care quality and patient safety.

Jennifer has an extensive background in leadership, organization development, and program management in both non-profit and education settings. Her previous experiences include serving as Senior Vice President at Stratis Health, as a Program Director at the University of Minnesota, Program Coordinator at Tufts University in Boston, and in other non-profit management positions.

She has a BA in speech communication and economics from Macalester College, an MBA in public and non-profit management from Boston University, and a PhD in Education with a focus on training and organization development from the University of Minnesota. Her dissertation research was "Teamwork and Safety Climates in Small Rural Hospitals," and she has published articles in peer reviewed journals on topics related to health quality and organizational change. Jennifer is Co-Chair of the Minnesota e-Health Initiative Advisory Committee; Vice Chair of the Minnesota Cancer Alliance Steering Committee; and a member of the Women's Health Leadership Trust and Minnesota Healthcare Quality Professionals. She is President Elect of the American Health Quality Association, and a member of the board of Minnesota Community Measurement. She was recently appointed as a member of the national RUPRI (Rural Policy Research Institute) Health Panel.



### **Walter Cooney, MA, JD, Executive Director, Neighborhood Healthcare Network; MN e-Health Advisory Committee Co-Chair**

Walter Cooney is the Executive Director of the Neighborhood Health Care Network, a consortium of 14 community health centers in the Twin Cities metro area. The Network provides management support services, including information technology systems, to its member clinics. Prior to joining the Network in 2006, Cooney held management positions with several local health care organizations, including Medica, Abbott Northwestern Hospital, and United Healthcare. He has a master's degree in health care administration from the University of Wisconsin, and a law degree from William Mitchell College of Law. He was appointed Co-Chair of the Minnesota e-Health Advisory Committee in September, 2008.

# HITECH Resources Panel Members

## **Alan Abramson, PhD, Senior Vice President, Information Services and Chief Information Officer, HealthPartners**

Mr. Abramson is responsible for the information systems across the HealthPartners enterprise, including health plan and care delivery operations. Alan has served as an advisor or board member to numerous regional and national organizations for healthcare systems innovation and improvement, including CHIME, HIMSS, Scottsdale Institute, Minnesota e-Health Steering Committee, RX2000 Institute, the Minnesota Health Data Institute, HealthPartners Research Foundation, University of St. Thomas Graduate Programs in Software, and Caring Bridge. He is the current Chair of the Managed Care Executive Group and a co-chair of the Minnesota eHIT Technology and Standards Workgroup. He is past Board President of the American Lung Association of Minnesota and currently serves as a member of the Board of the American Lung Association of the Upper Midwest. He graduated cum laude from Wheaton College in Illinois, and received a PhD from the University of Minnesota, with a concentration in computer applications and decision science.

## **Bob Paulsen, Coordinator, Medicaid Health Information Technology, Minnesota Department of Human Services**

Mr. Paulsen the HITECH Medicaid HIT initiatives, and their integration and alignment with the state's broader HIT efforts. Prior to his current position Bob worked in health care systems design and development as a Policy and Design Supervisor, Business Architect and Business Director. Previous to that, Bob was the supervisor of a health care policy initiatives and legislative development team. Bob recently served on the DHS enterprise architecture planning team and continues to work on enterprise architecture issues for health care within DHS. Bob has more than 17 years experience working with Minnesota's health care programs at both the county and state level.

## **Paul Kleeberg, MD, Clinical Director, Regional Extension Assistance Center for HIT (REACH)**

Dr. Kleeberg is the Clinical Director for the Regional Extension Assistance Center for HIT (REACH) funded by the recovery act to assist small hospitals and primary care providers in Minnesota and North Dakota adopt and become meaningful users of electronic health records (EHR). Dr. Kleeberg has over 16 years experience working as a family physician in a small clinic in greater Minnesota and later in a large health system. He also has over 18 years of experience in information technology implementing EHRs in ambulatory and hospital settings with issues such as the EHR selection process, physician engagement, build, workflow redesign, clinical content management, clinical decision support and overall EHR governance. Dr. Kleeberg received his medical degree from Stanford University School of Medicine and completed his residency in family medicine at the University of Minnesota. He is board certified in family medicine, is a fellow in both the American Academy of Family Physicians (AAFP) and in the Healthcare Information Management and Systems Society (HIMSS). Finally, he is a member of the Minnesota eHealth Advisory Committee, and has co-chaired several of their workgroups.

## **Julie Jacko, PhD, Professor of Public Health and Professor of Nursing, University of Minnesota**

In addition to her educational positions, Dr. Jacko directs the Institute for Health Informatics, a research institute of the University of Minnesota's Academic Health Center. She is the Principal Investigator of the HITECH grant received by the University of Minnesota and the College of St. Scholastica for a Program of Assistance for University-Based Training titled, "University Partnership for Health Informatics (UP-HI)." Dr. Jacko's research expertise is the design, implementation and evaluation of interactive, next-generation computing and informatics solutions in complex

domains including, but not limited to, healthcare and healthcare delivery, with the purpose of supporting the development of systems that are both usable and accessible. She currently serves on the MN e-Health Advisory Committee representing academics and clinical research for the State of Minnesota.

## **James Golden, PhD, Director, Division of Health Policy, Minnesota Department of Health**

Dr. Golden has been designated by the Governor as the State Government HIT Coordinator. His area of the Health Department is responsible for:

- Monitoring and tracking health care access, cost, and quality;
- Implementing Minnesota's current health reform efforts;
- Promoting the adoption, use and exchange of health information through EHRs;
- Implementing uniform billing and coding requirements;
- Promoting access to quality health care for rural and underserved urban Minnesotans through the Office of Rural Health and Primary Care;
- Administering the Medical Education and Research Cost fund to support medical education activities in Minnesota; and
- Maintaining the official, permanent state birth and death records for Minnesota.

Prior to joining the Department of Health, Dr. Golden was the chief operating officer for the Midwest Center for HIPAA Education. He also served as a Peace Corps volunteer in Paraguay. Dr. Golden earned his doctorate at the University of Minnesota's Carlson School of Management.

## **Christopher G. Chute, MD, DrPH, BioMedical Informatics, Mayo Clinic; Member, National Health IT Standards Committee, PI SHARP and Beacon Awards**

Dr. Chute received his undergraduate and medical training at Brown University, internal medicine residency at Dartmouth, and doctoral training in Epidemiology at Harvard. He is Board Certified in Internal Medicine, and a Fellow of the American College of Physicians, the American College of Epidemiology, and the American College of Medical Informatics. He became founding Chair of Biomedical Informatics at Mayo in 1988, stepping down after 20 years in that role. He is now Professor of Medical Informatics, and is PI on a large portfolio of research including the HHS/Office of the National Coordinator (ONC) SHARP (Strategic Health IT Advanced Research Projects) on Secondary EHR Data Use, the ONC Beacon Community (Co-PI), the LexGrid projects, Mayo's CTSA Informatics, Mayo's Cancer Center Informatics including caBIG, and several NIH grants including one of the eMERGE centers from NCHRI, which focus upon genome wide association studies against shared phenotypes derived from electronic medical records. Dr. Chute serves as Vice Chair of the Mayo Clinic Data Governance for Health Information Technology Standards, and on Mayo's enterprise IT Oversight Committee.

Beyond his work at Mayo, he is presently Chair, ISO Health Informatics Technical Committee (ISO TC215) and Chairs the World Health Organization (WHO) ICD-11 Revision. He also serves on strategic advisory panels to NCRR and NHGRI within NIH, and the Health Information Technology Standards Committee for the Office of the National Coordinator in the US DHHS. Recently held positions include Chair of the Biomedical Computing and Health Informatics study section at NIH, Chair of the Board of the HL7/FDA/NCI/CDISC BRIDG project, on the Board of the Clinical Data Interchange Standards Consortium (CDISC), ANSI Health Information Standards Technology Panel (HITSP) Board member, Chair of the US delegation to ISO TC215 for Health Informatics, Convener of Healthcare Concept Representation WG3 within the (TC215), Co-Chair of the HL7 Vocabulary Committee, Chair of the International Medical Informatics Association (IMIA) WG6 on Medical Concept Representation, American Medical Informatics Association (AMIA) Board member, and multiple other NIH biomedical informatics study sections as chair or member.

# Project Showcase

## **Community Health Information Collaborative (CHIC) - Health Information Exchange in Northern Minnesota**

404 West Superior Street, Suite #250, Duluth, MN 55802  
Contact: Cheryl Stephens, PhD, 218-625-5515, [cstephens@medinfosystems.org](mailto:cstephens@medinfosystems.org)  
Project web site: [www.medinfosystems.org](http://www.medinfosystems.org); [www.hiebridge.org](http://www.hiebridge.org), [www.healthbio.org](http://www.healthbio.org)

### **Health Information Exchange in Northern Minnesota**

Our primary initiative is the current implementation of a record locator service (HIE-Bridge™) with hospitals, clinics, and long-term care facilities across northeastern Minnesota. Many of the efforts involved in this project are based on our experiences as one of the participants in the Nationwide Health Information Network project, sponsored by Office of the National Coordinator (ONC). We are also one of 15 HIE's involved with the Social Security Administration to begin processing disability applications using the NHIN. CHIC's personal health record, HealthBio™, is designed to participate in the HIE-Bridge architecture or may be used as a stand-alone offering for organizations supporting vulnerable populations, such as nursing homes and homes for adults with developmental disabilities.

Other partnering organizations: Essentia/SMDC Health System, St. Luke's, Kanabec Hospital, Mercy Hospital, Pine Medical Center, Cook Hospital, Ecumen, Northern Minnesota Network clinics

---

## **HIMSS Minnesota Chapter**

1292 Nursery Hill Lane, Arden Hills, MN 55112  
Contact: Tamara Winden, 612-262-6078, [tamara.winden@allina.com](mailto:tamara.winden@allina.com)  
Project web site: [www.himss-mn.org](http://www.himss-mn.org)

### **HIMSS-MN Chapter**

The Minnesota Chapter of HIMSS (Healthcare Information and Management Systems Society) is a not-for-profit organization dedicated to promoting a better understanding of health care information and management systems. National HIMSS has more than 40 affiliated chapters and interest groups across the United States and Latin America. HIMSS Affiliated Chapters serve a valuable role in bringing health care systems professionals together in a local forum, to discuss issues and developments, learn about new methods and tools, and network with others having similar experiences. Each chapter shares the same basic knowledge among colleagues and to assist members in their professional growth.

---

## **Lac qui Parle Health Network**

900 2<sup>nd</sup> Avenue, Madison, MN 56256  
Contact: Mark Roisen, 320-598-7536, [mroisen@farmerstel.net](mailto:mroisen@farmerstel.net)  
Project web site: [www.appletonareahealth.com](http://www.appletonareahealth.com) — [www.jmhsdawson.com](http://www.jmhsdawson.com) — <http://mlhmn.org>

### **LqPHN EHR Selection/Implementation/on-going quality improvement**

The Lac qui Parle Health Network with support from the MDH and Stratis Health coordinated the selection, implementation and training of an interoperable electronic health record systems for its three hospital based members: Johnson Memorial Health Services, Madison Lutheran Home and Appleton Area Health Services. Since the project's completion, the IT Steering Committee has changed its focus and is now focused on quality improvement and meaningful use.

---

## **Mayo Clinic**

200 1<sup>st</sup> Street SW, Rochester, MN 55905  
Contact: Lacey Hart, 507-293-3780, [hart.lacey@mayo.edu](mailto:hart.lacey@mayo.edu)  
Project Website: <http://sharpn.org> -or- <http://informatics.mayo.edu/beam>

### **Beacon and SHARP Healthcare IT Initiatives**

Mayo Clinic's SHARP program will enhance patient safety and improve patient medical outcomes through the use of an electronic health record. By creating tangible tools, services and software for large-scale health record data sharing, the projects under this program will ultimately help improve the quality and efficiency of patient care through the use of an electronic health care record.

Under the Beacon initiative, the 11-county region of southeast Minnesota will collaborate to adopt meaningful-use health information technology (HIT) standards and health information exchange (HIE), with childhood asthma and adult diabetes metrics. Childhood asthma management will expand into the schools, health departments, and providers from an existing pilot in Olmsted County involving Rochester School District 535, Olmsted Public Health, OMC, and Mayo. Diabetes management will include shared decision-making and county health services. The region also includes government HIT-related organizations, including Prairie Island Indian Reservation, a VA clinic, and a federal prison hospital.

# Project Showcase

## **Minnesota Department of Health — Asthma Program**

85 E. 7<sup>th</sup> Place, Golden Rule Building, St. Paul, MN 55164

Contact: Susan K. Ross, 651-201-5629, susan.ross@state.mn.us

Project web site: [www.Asthma-iAAP.com](http://www.Asthma-iAAP.com)

## **The Interactive Asthma Action Plan (iAAP) — Integrating the NIH, EPR-3 Asthma Guidelines into a Computerized Clinical Decision Support Tool**

During the 2007 state asthma planning process, health professionals recommended to the Minnesota Department of Health (MDH) that resources be available to enable prescribing clinicians to better incorporate the revised 2007 NIH EPR-3 asthma guidelines into their practice, thus enhancing their ability to accurately assess, treat, prescribe for and educate their patients who have asthma. In 2003, MDH released a computerized clinical decision support tool based on the EPR-2 asthma guidelines. Clinicians from our state plan workgroup made updating the “old” iAAP a priority in order to help prescribing clinician successfully utilize and understand the revised guidelines. The iAAP was developed for prescribing clinicians to enhance their ability to help asthma patients achieve optimal asthma control, thereby reducing asthma hospitalizations and emergency department visits.

---

## **Minnesota Department of Health — Health Care Homes**

Golden Rule Building, 85 E. 7<sup>th</sup> Place, Suite 220, P.O. Box 64882, St. Paul, MN 55164

Contact: Emily Dale, 651-201-5421, emily.dale@state.mn.us

Project web site: [www.health.state.mn.us/healthreform/homes](http://www.health.state.mn.us/healthreform/homes)

## **Health Care Homes: Low-cost and no-cost registry options for health care homes**

As part of 2008 Health Reform legislation, primary care clinics and/or clinicians in the State of MN can apply to become certified as a Health Care Home. One of the certification requirements is to systematically manage patient information and to use the information for population management to support care coordination in a readily accessible, electronic registry. Through a contract with MDH, Stratis Health researched and reported upon registry options for those primary care clinics and/or clinicians interested in certification. MDH will present the findings of this research and share information about Health Care Homes.

---

## **Minnesota Department of Health — The Minnesota Disease Surveillance Modernization Project**

625 Robert Street, P.O. Box 64975, St. Paul, MN 55164

Contact: Asa Schmit, 651-201-5023, asa.schmit@state.mn.us

Project web site: [www.health.state.mn.us/medss](http://www.health.state.mn.us/medss)

## **The Minnesota Disease Surveillance Modernization Project**

This project provides for the staged development of an integrated and shared disease surveillance system for the State of Minnesota that will comply with the Centers for Disease Control and Prevention (CDC) Public Health Information Network (PHIN) requirements. It will improve the detection and response to bio-terrorism events, disease outbreaks and trends in diseases by improving the detection, monitoring, analysis and electronic information exchange of infectious and chronic disease data.

This project will modernize the disease surveillance information systems at the Minnesota Department of Health in a manner that it:

- is compliant with federal PHIN requirements;
- allows MDH to meet the needs of our private and public sector reporting partners through standardized electronic exchange of disease information;
- improves monitoring and analysis of disease data;
- improves responses to outbreaks, public health emergencies and trends in preventable disease

# Project Showcase

## **Minnesota Department of Health— Minnesota Immunization Information Connection (MIIC)**

625 Robert Street, St. Paul, MN 55164

Contact: Emily Peterson, 651-201-5546, emily.peterson@state.mn.us

Project web site: [www.health.state.mn.us/divs/idepc/immunize/registry](http://www.health.state.mn.us/divs/idepc/immunize/registry)

### **Minnesota Immunization Information Connection (MIIC)**

MIIC the statewide web-based immunization information system that contains a complete and accurate record of a person's immunizations, no matter where they received the shots. It is accessed by health care providers, public health agencies, schools and other immunization providers with the main objective of preventing disease through immunization. Our goals include to increase and sustain high immunization coverage rates through effective use of high quality data; to improve immunization practice by providing clinical decision support through consolidated immunization histories and expert vaccine forecasting; to improve vaccine accountability by reducing unnecessary or inappropriate doses; and to position MIIC as a powerful tool to assist clinics with quality assurance measures.



## **Minnesota Department of Health — Office of Rural Health and Primary Care**

P.O. Box 64882, St. Paul, MN 55164

Contact: Anne Schloegel, 651-201-3850, anne.schloegel@state.mn.us

Project web site: [www.health.state.mn.us/divs/orhpc](http://www.health.state.mn.us/divs/orhpc)

### **Office of Rural Health and Primary Care**

Office of Rural Health and Primary Care Mission: to promote access to quality health care for rural and underserved Minnesotans. From our unique position within state government, we work as partners with communities, providers, policymakers and other organizations. Together, we develop innovative approaches and tailor our tools and resources to the diverse populations we serve. The Office of Rural Health and Primary Care provides financial and technical assistance for safety net providers, promotes health care access and quality through policy, partnerships and innovations, and supports health care workforce development. The Office of Rural Health and Primary Care offers several loan forgiveness and loan repayment programs to health care students or residents. In addition, funding for health information technology is available through many of the grant programs and EHR loan program managed by the Office of Rural Health and Primary Care.



## **Minnesota Disability Determination Services: Electronic Records Initiative**

121 East 7<sup>th</sup> Place, St. Paul, MN 55101

Contact: Heather Mittica, 651-259-7812, heather.mittica@ssa.gov

Project web site: [www.ssa.gov/ere](http://www.ssa.gov/ere)

### **Electronic Records Initiative**

The current project goal is to increase the percentage of medical treatment records submitted in an electronic format to 50%. Our purpose is to better serve Social Security Administration's (SSA) Disability Program's clients by providing a high quality decision with decreased processing time. The percentage of electronic medical records submissions has increased from 12% in 2006 to 43% in 2010.

Actions to accomplish our goal include the following:

- Implementation of an electronic records extract on a national basis with the Veterans Medical Centers.
- Expansion of electronic outbound faxed requests to medical facilities.
- Expansion of electronic requests sent via a secure website.
- Increased use of faxed electronic medical records documents to a secure fax server.
- Increased faxing of paper records that arrive as imaged files in the electronic disability folder.
- Use of secure bulk electronic transfer technology for high volume sources of medical records.

# Project Showcase

## Minnesota Health Information Management Association

P.O. Box 16245, Duluth, MN 55816

Contact: Myrna Wells-Ulland, 218-340-6735, [executivedirector@mnhima.org](mailto:executivedirector@mnhima.org)

Project web site: [www.mnhima.org](http://www.mnhima.org)

### Association of health information management professionals involved with and supporting e-Health initiatives in Minnesota healthcare facilities.

Professional association of 1800+ members with an annual strategic focus on educating our membership in MN e-health initiatives and RHIOs; engaging HIM professionals in sharing their EHR planning and implementation experiences; providing training for and conducting consumer education sessions to inform and advocate for the personal health record; and supporting our membership's efforts to maintain the integrity of the legal health record.

---

## Minnesota Rural Health Cooperative

190 East 4<sup>th</sup> Street North, Cottonwood, MN 56229

Contact: Chuck Ness, 507-423-5300, [cness@mrhc.net](mailto:cness@mrhc.net)

Project web site: [www.mrhc.net](http://www.mrhc.net)

### Shared HIT Project

The Minnesota Rural Health Cooperative (MRHC) and project participants will partner with Healthland (formerly Dairyland Health Systems), and other leading healthcare HIT vendors as needed, to provide quality EHR systems and support services and address all care delivery environments. Software/hardware group purchasing, licensing (e.g. Microsoft) and contract negotiations will be used to reduce costs to the participants. Vendor projects will be fully integrated and supported with multiple standard interfaces between EHR products. Training facilities and on-going training programs will be implemented to support all shared EHR applications.

A shared data center will be established to host software/hardware applications in a secure, reliable and high availability environment. Each site will be connected to the data center via reliable and redundant high-speed network connections. The shared data center will include shared IT staff, production support to ensure 24/7 computer operations, help desk, problem management, customer support and disaster recovery plans/backups.

---

## Normandale Community College — Healthcare Informatics Initiatives

9700 France Avenue S., Bloomington, MN 55431

Contact: Shirley Beil, 952-487-8422, [shirley.beil@normandale.edu](mailto:shirley.beil@normandale.edu)

### Normandale Community College's Healthcare Informatics Initiatives

**Short Term Training:** Normandale Community College was recently awarded an \$800,000 portion of the Community College Consortia Program from the U.S. Department of Health and Human Services enabling the college to train 300 people over the next two years to meet a workforce need in the rapidly growing field of health information technology (HIT). Normandale, along with 70 other colleges nationwide, will use the grant funds to provide training, starting in September, to current and future healthcare workers who will integrate electronic health record information systems at hospitals, doctor's offices and other medical facilities throughout the nation. Each college will create training programs that can be completed in six months or less by individuals with appropriate prior education and/or experience.

**AAS Degree:** Normandale has also designed an Associate in Applied Science in Healthcare Informatics. This will be a 2 year program of 18 courses consisting of 6 General Education courses (e.g. Freshman Composition, Communications, and Statistics) and the 12 courses needed for students without prior education in the field to seamlessly integrate knowledge of information technology with health care data and processes across a variety of systems.

**Certificates:** Students who already have a strong background in IT including systems design and object-oriented programming will be able to complete five courses that will provide the specifics needed for Health IT. Whereas students with a health care background will be able to complete a different 5 courses to gain the necessary mastery with IT. Each of these pathways will lead to a certificate.

# Industry Expo Map

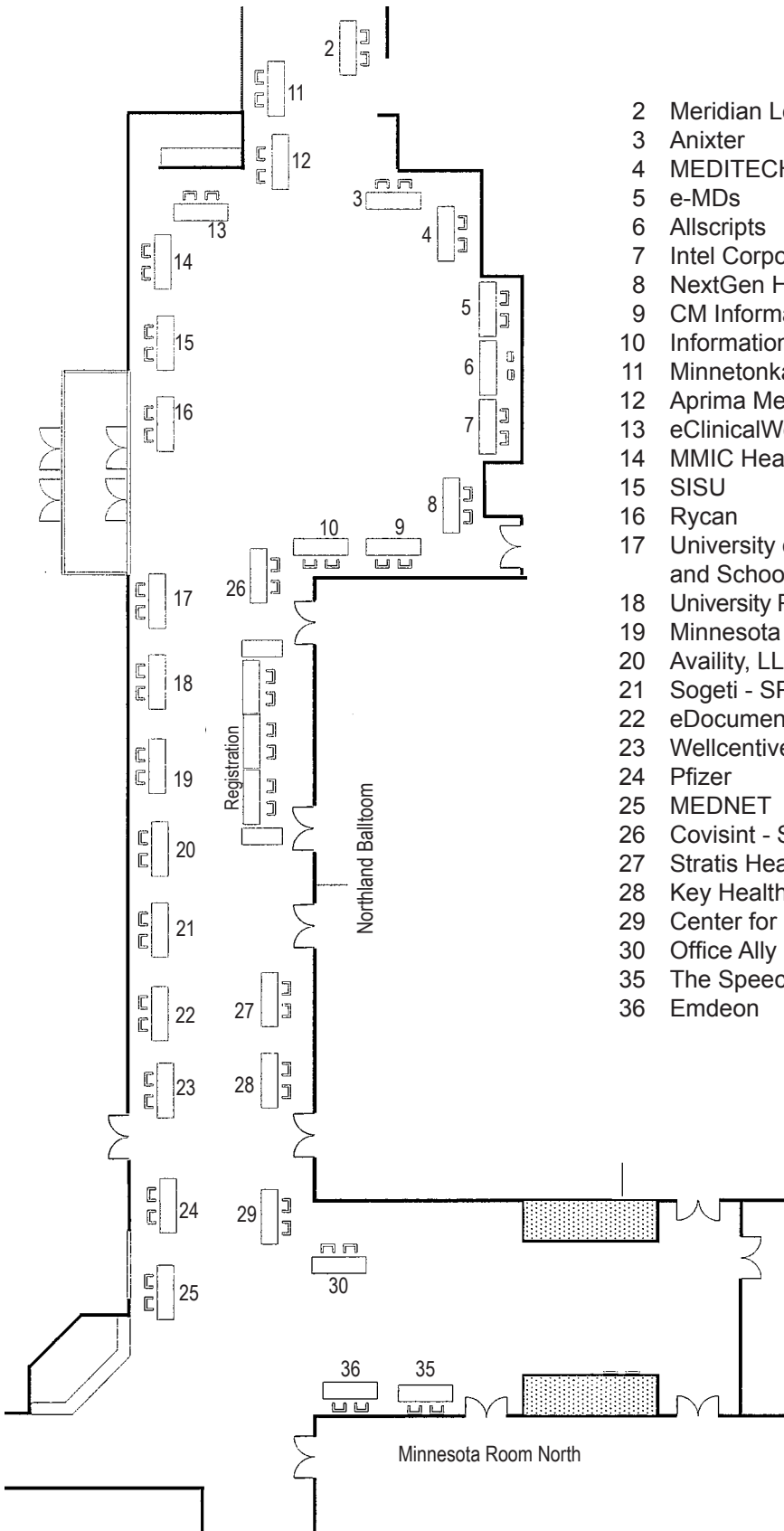

- 2 Meridian Leasing Corporation
- 3 Anixter
- 4 MEDITECH (Medical Information Technology, Inc.)
- 5 e-MDs
- 6 Allscripts
- 7 Intel Corporation
- 8 NextGen Healthcare
- 9 CM Information Specialists
- 10 Information Builders
- 11 Minnetonka Medical Technology/Advent
- 12 Aprima Medical Software
- 13 eClinicalWorks
- 14 MMIC Health IT
- 15 SISU
- 16 Rycan
- 17 University of Minnesota: Institute for Health Informatics and School of Nursing - SPONSOR
- 18 University Partnership for Health Informatics (UP-HI) - SPONSOR
- 19 Minnesota Health Information Exchange
- 20 Availity, LLC - SPONSOR
- 21 Sogeti - SPONSOR
- 22 eDocument Resources
- 23 Wellcentive
- 24 Pfizer
- 25 MEDNET
- 26 Covisint - SPONSOR
- 27 Stratis Health - SUMMIT PARTNER
- 28 Key Health Alliance - SUMMIT PARTNER
- 29 Center for Health Care Innovation
- 30 Office Ally
- 35 The Speech Gurus, LLC
- 36 Emdeon

# Industry Expo Guide

BOOTH #6

## Allscripts

[www.allscripts.com](http://www.allscripts.com)

8529 Six Forks Road, Raleigh, NC 27615

Contact: Emelia Altschul, Reseller Marketing Manager  
[emelia.altschul@allscripts.com](mailto:emelia.altschul@allscripts.com) — 919-329-1773

Allscripts uses innovation technology to bring health to healthcare. More than 160,000 physicians, 800 hospitals and nearly 8,000 post-acute and homecare organizations utilize Allscripts to improve the health of their patients and their bottom line. The company's award-winning solutions include electronic health records, electronic prescribing, revenue cycle management, practice management, document management, hospital care management, emergency department information systems and homecare automation. To learn more, visit [www.allscripts.com](http://www.allscripts.com)

BOOTH #3

## Anixter

[www.Anixter.com](http://www.Anixter.com)

6055 Nathan Lane North, Plymouth, MN 55442

Contact: Donna Cochran, Director of Sales  
[donna.cochrane@anixter.com](mailto:donna.cochrane@anixter.com) — 763-559-2690

A leading global supplier of network infrastructure, communications & security products. We help our customers specify solutions and make informed decisions around technology applications & relevant standards. Throughout the world, we provide innovated supply chain management services and technical expertise to reduce our customers' total cost of production and implementation. We focus on our customers' business needs and apply the right technical support and supply chain efficiencies for project cost reductions.

BOOTH # 12

## Aprima Medical Software

[www.aprima.com](http://www.aprima.com)

3330 Keller Springs Road, #201, Carrollbow, TX 75006

Contact: Mark Geinopolos, Sales Executive  
[mgeinopolos@aprima.com](mailto:mgeinopolos@aprima.com) — 414-524-9789

Aprima's template-free EHR/PM enables physicians to maintain their own workflows, not force them to conform to practice-wide standards. Licensing plans make sense for everyone from solo rural practitioners to multi-specialty urban groups. Computer-based training accelerates adoption and helps practices fulfill "meaningful use" criteria. [Aprima.com](http://Aprima.com). 866-960-6890.  
[salesinfo@aprima.com](mailto:salesinfo@aprima.com)

BOOTH #20

## Availity, LLC

[www.availity.com](http://www.availity.com)

7406 Fullerton Street, Suite 300, Jacksonville, FL 32256

Contact: Drew Vaughn, Regional Manager  
[dvaughn@availity.com](mailto:dvaughn@availity.com) — 800-282-4548

About Availity – Patients. Not paperwork.®  
The Availity® Health Information Network encompasses administrative, financial, and clinical services, supporting both real-time and batch electronic data interchange (EDI) via the Web and business to business (B2B) integration.

BRONZE  
SPONSOR

## Blue Cross and Blue Shield of Minnesota

[www.bluecrossmn.com](http://www.bluecrossmn.com)

P.O. Box 64560, St. Paul, MN 55164

Contact: Jim Eppel, Sr. Vice President, Health  
Management and Commercial Markets  
[james\\_w\\_eppel@bluecrossmn.com](mailto:james_w_eppel@bluecrossmn.com) — 651-662-1096

Blue Cross and Blue Shield of Minnesota, with headquarters in the St. Paul suburb of Eagan, was chartered in 1933 as Minnesota's first health plan and continues to carry out its charter mission today: to promote a wider, more economical and timely availability of health services for the people of Minnesota. A nonprofit, taxable organization, Blue Cross is the largest health plan based in Minnesota, covering 2.7 million members in Minnesota and nationally through its health plans or plans administered by its affiliated companies. Blue Cross and Blue Shield of Minnesota is an independent licensee of the Blue Cross and Blue Shield Association, headquartered in Chicago. Go to [www.bluecrossmn.com](http://www.bluecrossmn.com) to learn more about Blue Cross and Blue Shield of Minnesota. Each Blue Cross and Blue Shield plan is an independent licensee of the Blue Cross and Blue Shield Association.

SILVER  
SPONSOR

BOOTH #29

## Center for Healthcare Innovation at the College of St. Scholastica

[www.centerforhealthcareinnovation.com](http://www.centerforhealthcareinnovation.com)

1200 Kenwood Ave., Room S1117, Duluth, MN 55811-4199

Contact: Ryan Sandefer, Research Coordinator  
[rsandefer@css.edu](mailto:rsandefer@css.edu) — 218-625-4931

The Center for Healthcare Innovation at the College of St. Scholastica is driven to assist healthcare organizations successfully implement and meaningfully use their EHR's. The Center also offers a robust, commercially proven, real-world electronic health record system to teaching institutions via the Academic EHR System Subscription Service. The College of St. Scholastica is recognized as a leader in education health professionals in the method of care they will encounter in the workplace.

## BOOTH #9

### CM Information Specialists

[www.cminfospec.com](http://www.cminfospec.com)

[www.secure4sending.com](http://www.secure4sending.com)

6875 Highway 65 NE, Fridley, MN 55432

Contact: Bonnie Coffey, President/CEO

[bcoffey@cminfospec.com](mailto:bcoffey@cminfospec.com) — 763-572-0802

Our roots are in the release of information (ROI). Copying and mailing records have been replaced with our proprietary application Secure4Sending, allowing the user to send medical information securely and quickly replacing copying, printing and mailing or faxing medical information. Interoperability with all electronic medical records also a feature of this application. It's intuitive, tracks requests and accounts for disclosures. See Bonnie Coffey or Ron Raymond for more information.

## BOOTH #26

### Covisint

[www.covisint.com](http://www.covisint.com)

One Cumpas, Detroit, MI 48226

Contact: Denis Dudzinski

[ddudzinski@covisint.com](mailto:ddudzinski@covisint.com) — 313-227-6410

Covisint enables information ecosystems by providing secure communication and collaboration between people and systems in remarkably simple ways. Covisint is a recognized cloud computing pioneer driving the on-demand revolution that helps organizations connect, communicate and collaborate with their partners – enabling anywhere, anytime information. Covisint's ExchangeLink™ platform provides industry-specific services for identity management, collaborative portals and data exchange, as well as third-party application marketplace.



## BOOTH #13

### eClinicalWorks

[www.eclinicalworks.com](http://www.eclinicalworks.com)

112 Turnpike Road, Westborough, MA 01581

Contact: Heather Caouette, PR/Marketing

[heather.c@eclinicalworks.com](mailto:heather.c@eclinicalworks.com) — 508-836-2700

eClinicalWorks develops and implements ambulatory clinical solutions consisting of EMR and practice management software, patient portals and a community health records application. With more than 40,000 providers and 120,000 medical professionals across all 50 states using its solutions, customers include small, medium and large physician practices, out-patient departments of hospitals, health centers, departments of health and convenient care clinics.

## BOOTH #22

### e-Document Resources

[www.edocumentresources.com](http://www.edocumentresources.com)

6101 Baker Road, Suite 207, Minnetonka, MN 55345

Contact: Pat Thomas, HealthCare Account Manager  
[pthomas@edocumentresources.com](mailto:pthomas@edocumentresources.com) — 952-607-3500 or

Trevor Rossum, HealthCare Account Manager

[trossum@edocumentresources.com](mailto:trossum@edocumentresources.com) — 952-607-3500

eDocument Resources' enterprise-wide content management solution offers healthcare organizations a complementary and synergistic solution that serves as a bridge to EMR and financial systems. Our breadth of functionality includes: front office registration, revenue cycle, denial management/secondary billing, medical records management, automation of the deficiency process, ROI, credentialing, human resources, and managing accounts payable/purchasing. For more information go to: [www.edocumentresources.com](http://www.edocumentresources.com)

## BOOTH #5

### e-MDs

[www.e-mds.com](http://www.e-mds.com)

9900 Spectrum Drive, Austin, TX 78717

Contact: William Rice, Marketing Manager

[wrice@e-mds.com](mailto:wrice@e-mds.com) — 512-767-6195

e-MDs is a leading developer of health care software solutions, active in national HIT and interoperability efforts. e-MDs Solution Series™ is the standard for affordable, integrated EHR/Practice Management software, including clinical, financial and document management modules designed to automate medical practice processes and chart management. Solution Series is designed to improve care, reduce errors and simplify business, ensuring time spent with patients is billed and coded properly.

## BOOTH #36

### Emdeon

[www.emdeon.com](http://www.emdeon.com)

3055 Lebanon Pike, Nashville, TN 37214

Contact: Robb Larsen, Account Executive

[rlarsen@emdeon.com](mailto:rlarsen@emdeon.com) — 651-429-0831

Emdeon is a leading provider of revenue and payment cycle solutions that connect payers, providers and patients to integrate and automate key business and administrative functions throughout the patient encounter. Through the use of Emdeon's comprehensive suite of products and services, its customers are able to improve efficiency, reduce costs, increase cash flow and more efficiently manage the complex revenue and payment cycle process.

BRONZE  
SPONSOR

## HealthPartners

[www.healthpartners.com](http://www.healthpartners.com)

8170 33<sup>rd</sup> Avenue So., Bloomington, MN 55425  
Contact: Gina Hall, Sr. Director IS & T Services Delivery  
[gina.t.hall@healthpartners.com](mailto:gina.t.hall@healthpartners.com) — 952-967-7735 or  
Kristi King, Sr. Administrative Assistant  
[Kristina.m.king@healthpartners.com](mailto:Kristina.m.king@healthpartners.com)

Founded in 1957, the HealthPartners ([www.healthpartners.com](http://www.healthpartners.com)) family of healthcare companies serves more than one million medical and dental health plan members nationwide. It is the largest consumer-governed, nonprofit health care organization in the nation, providing care, coverage, research and education to improve the health of members, patients and the community. For the fourth year in a row, HealthPartners is rated one of the best commercial health plans in the nation by U.S. News & World Report, NCQA's "America's Best Health Plans 2008."

## BOOTH #10

### Information Builders

[www.informationbuilders.com](http://www.informationbuilders.com)

444 Cedar Street, Suite 2000, St. Paul MN 55101  
Contact: Carl Wangberg, Area Manager  
[carl\\_wangberg@ibi.com](mailto:carl_wangberg@ibi.com) — 651-602-9100

Information Builders helps healthcare providers improve quality of care and customer satisfaction while lowering costs and increasing revenue. Our solutions provide front-office reporting, query and analysis capabilities to physicians and nursing staff, while streamlining back-office business processes to improve patient care, automate eligibility verification and electronic workflow all while adhering to governmental regulations.

## BOOTH #7

### Intel Corporation

[www.intel.com](http://www.intel.com)

3600 W. American Blvd, Suite 450, Bloomington, MN 55431  
Contact: Tom Halter  
[tom.halter@intel.com](mailto:tom.halter@intel.com) — 612-803-6251

Informed by more than a decade of ethnographic studies, Intel has a vision of using innovative technologies to transform healthcare, improve chronic disease management, and enhance wellness and independence. Intel is connecting people and information for more personalized and effective management of chronic conditions in the home.

## BOOTH #28

### Key Health Alliance

[www.khaREACH.org](http://www.khaREACH.org)

c/o Stratis Health, 2801 Metro Drive, Suite 300,  
Bloomington, MN 55425952-853-5838  
Contact: Sue Severson, Project Director  
[sseverson@stratishealth.org](mailto:sseverson@stratishealth.org)

Key Health Alliance is a partnership of Stratis Health, National Rural Health Resource Center and The College of St. Scholastica developed to help meet the needs of rural and underserved populations. It currently operates the Regional Extension Assistance Center for HIT (REACH) – dedicated to helping providers in clinics, small hospitals, and other settings in Minnesota and North Dakota implement and effectively use electronic health records – in collaboration with North Dakota Health Care Review and the University of North Dakota.

SUMMIT  
PARTNER

## BOOTH #4

### MEDITECH

[www.meditech.com](http://www.meditech.com)

Meditech Circle, Westwood, MA 02090  
Contact: Carl Shapiro, Marketing Consultant  
[cdshapiro@meditech.com](mailto:cdshapiro@meditech.com) — 781-821-3000

MEDITECH (Medical Information Technology, Inc.) has been the leader in the Health Care Information Systems (HCIS) industry since 1969. MEDITECH's applications unify clinical, administrative, and financial information across a health care organization, including acute care, long-term care, home health care, and physician practices. Today, more than 2,000 customers worldwide use MEDITECH's information systems.

## BOOTH #25

### MEDNET

[www.mednetworld.com](http://www.mednetworld.com)

333 Washington Avenue N, #208, Minneapolis, MN 55401  
Contact: Chris Smith, Director of Business Development  
[chris.smith@mednetworld.com](mailto:chris.smith@mednetworld.com) — 612-435-7603

MEDNET is the industry leader in connecting healthcare to improve patient care. MEDNET builds your Health Information Exchange to be secure and fully compliant with NHIN standards; ensuring federal connectivity and guaranteeing universal compatibility—now and into the future.

## BOOTH #2

### **Meridian Leasing Corporation**

**[www.meridianleasing.net](http://www.meridianleasing.net)**

5775 Wayzata Blvd, #850, St. Louis Park, MN 55416

Contact: Chad McShane, Account Representative  
[cmcshane@meridianleasing.net](mailto:cmcshane@meridianleasing.net) — 952-544-7952

Meridian Leasing is one of the country's largest independent leasing companies and is an innovator in the design of highly flexible financing structures. Meridian Leasing offers creative lease financing solutions for a myriad of equipment types and industries including technology information, healthcare and manufacturing.

## BOOTH #19

### **Minnesota Health Information Exchange**

**[www.mnhie.org](http://www.mnhie.org)**

P.O. Box 21126, Eagan, MN 55121

Contact: Anne Dobbins, Operations Director  
[annedobbins@mnhie.org](mailto:annedobbins@mnhie.org) — 651-747-7867

MN HIE is a public/private collaborative dedicated to the federal and state vision of accelerating the adoption of health information technology (HIT). It is the state-wide secure electronic network designed to share relevant administrative and clinical information among providers in Minnesota and bordering states to improve the health of all Minnesotans through more informed decision-making by the provider and patient at the point of care. MN HIE is committed to offering services that provide all necessary exchange capabilities to meet Meaningful Use criteria over the next four years.

## BOOTH #11

### **Minnetonka Medical Technology/Advent**

**[www.mmtmed.com](http://www.mmtmed.com)**

6322 Ginger Driver, Eden Prairie, MN 55346

Contact: Gavin Keogh, President  
[gavin@mmtmed.com](mailto:gavin@mmtmed.com) — 952-224-2408

Simple Admit is a progressive business solution that provides Surgery Centers an advanced web solution (SaaS) for secure pre-admissions that enhance quality of care and patient satisfaction. For patients Simple Admit is easy, private, and convenient. Patients complete the secure web form wherever and whenever they choose. Clinical staff gain more legible, complete medical histories and patient information since patients are completing the form themselves. This is accomplished over a secure HIPPA compliant server.

## BOOTH #14

### **MMIC Health IT**

**[www.mmicgroup.com](http://www.mmicgroup.com)**

7600 Edinborough Way, #400, Minneapolis, MN 55435

Contact: Brian Salzman, Sales Manager

[brian.salzman@mmicgroup.com](mailto:brian.salzman@mmicgroup.com) — 952-838-6843

MMIC Health IT, a division of MMIC Group, offers a complete range of IT services, from EHR consulting and IT outsourcing to interoperability services and website development. We are a value-added reseller (VAR) of NextGen® Electronic Health Record and Enterprise Practice Management systems. We serve more than 1,500 physicians, in a variety of settings and specialists. Our team of highly-experienced implementation, network and development professionals brings a combination of healthcare experience, practice knowledge, business and technical skills that provides an insider's understanding and appreciation for the day-to-day challenges of managing a medical practice.

## BOOTH #8

### **NextGen Healthcare**

**[www.nextgen.com](http://www.nextgen.com)**

795 Horsham Road, Horsham, PA 19044

Contact: Courtney Marshall

[cmarshall@nextgen.com](mailto:cmarshall@nextgen.com) — 215-385-7813

NextGen Healthcare is a full-service organization serving the needs of physician practices, hospitals, health centers, and other healthcare providers. With an integrated line of software products, business services, and strategic consulting, we help healthcare entities:

- Succeed in providing high-level care
- Optimize their revenue
- Manage their information
- Grow and thrive as a business

## BOOTH #30

### **Office Ally**

**[www.officeally.com](http://www.officeally.com)**

16703 SE McGillivray Blvd, #200, Vancouver, WA 98683

866-575-4120 ext. 3

Office Ally offers a suite of internet based solutions FREE to the provider. A full service clearinghouse, free Practice Management System, Personal Health Records, and our comprehensive EHR for only \$29.95 per month/provider. Set up and training, 24/7 tech-support, real time transactions, ERA's, order labs and prescriptions online...all FREE. To enroll: [www.officeally.com](http://www.officeally.com) or call 866-575-4120.

# Industry Expo Guide

BOOTH #24

## Pfizer

[www.pfizer.com](http://www.pfizer.com)

11515 Hillcrest Court N, White Bear Lake, MN 55110

Contact: Jim Collins, Customer Alliance Director

[james.e.collins@pfizer.com](mailto:james.e.collins@pfizer.com) — 612-840-4860

Pfizer provides a variety of prescription medications and resources that span a wide scope of therapeutic areas.

BOOTH #16

## Rycan

[www.rycan.com](http://www.rycan.com)

P.O. Box 306, Marshall, MN 56258

Contact: Jody Heard, Sales Executive

[jodyh@rycan.com](mailto:jodyh@rycan.com) — 800-201-3324 ext. 305

Rycan empowers healthcare providers to accelerate their revenue cycle through a suite of comprehensive, web-based solutions designed to improve productivity and increase reimbursement. Our solutions simplify the difficult tasks of remittance, denial, and contract management, RAC audit tracking, charge estimation, eligibility verification, claim submission and claim scrubbing. Contact us to see why at Rycan. We have a better solution.

BOOTH #15

## SISU

[www.sisunet.org](http://www.sisunet.org)

5 West 1<sup>st</sup> Street, Suite 200, Duluth, MN 55802

Contact: Wade Carlson, Sales Representative

[wcarlson@sisunet.org](mailto:wcarlson@sisunet.org) — 218-529-7993

SISU Medical Systems is a consortium of medical centers located throughout greater Minnesota and working together to share information technology resources. SISU Medical Systems provides cost effective information technology to provider based healthcare organizations. We are the experts bringing valuable information technology to healthcare providers. We research, implement and support the best IT solutions for our members.

BOOTH #21

## Sogeti USA

[www.us-sogeti.com](http://www.us-sogeti.com)

Two Meridian Crossings, Suite 670, Richfield, MN 55423

Contact: Andrew Tessier, Vice President, Healthcare

[Andrew.tessier@us.sogeti.com](mailto:Andrew.tessier@us.sogeti.com) — 612-644-9132

Sogeti USA is a leader in helping clients develop, implement and manage practical IT solutions to help run their business better. Sogeti garners experts from health care, finance, retail and public sector industries to offer services including Enterprise Microsoft Solutions, Enterprise Solutions Consulting, High Tech Consulting, IBM and Open Solutions and Testing/Quality Assurance. For more, visit [www.us.sogeti.com](http://www.us.sogeti.com).



BOOTH #35

## The Speech Gurus, LLC

[www.thespeechgurus.com](http://www.thespeechgurus.com)

8484 Cortland Road, Eden Prairie, MN 55344

Contact: Jon Swenson Tellekson, Owner

[jon@thespeechgurus.com](mailto:jon@thespeechgurus.com) — 888-641-6776 ext. 2

The Speech Gurus specialize in integrating Dragon® Medical speech recognition software with Electronic Health Records. Dragon® Medical can improve the experience of EHR adoption by improving physician productivity in documenting and providing care. This improved documentation can also result in increased reimbursement. We help with the entire process from initial planning through implementation, training and follow-up technical support.

BOOTH #27

## Stratis Health

[www.stratishealth.org](http://www.stratishealth.org)

2801 Metro Drive, Suite 300, Bloomington, MN 55425

Contact: Sue Severson, Director, Health Information

Technology Services

[sseverson@stratishealth.org](mailto:sseverson@stratishealth.org) — 952-853-8538

Stratis Health is a nonprofit organization that leads collaboration and innovation in health care quality and safety, and serves as a trusted expert in facilitating improvement for people and communities. More than 100 Minnesota adult primary care clinics and hospitals have used our EHR adoption and implementation services and support. HIT Toolkits for various settings are available on our Web site.



# Industry Expo Guide

BOOTH #17

## University of Minnesota: Institute for Health Informatics & School of Nursing

[www.ihl.umn.edu](http://www.ihl.umn.edu) and [www.nursing.umn.edu/home](http://www.nursing.umn.edu/home)  
MMC 912, 420 Delaware Street SE, Minneapolis, MN  
55455/WDH 5-140, 308 Harvard Street SE  
Contact: Jennifer Trochinski (IHI), Programs and  
Operations Manager, [troc0021@umn.edu](mailto:troc0021@umn.edu) or  
Bonnie Westra, PhD, RN, FAAN (SoN), Assistant  
Professor, [westr006@umn.edu](mailto:westr006@umn.edu)

The IHI was formed virtually in 2005 and launched as a physical entity in 2009 to link the growing health informatics-related research, teaching and outreach functions at the university, optimizing opportunities for coordination, synergy, and collaboration. The School of Nursing offers baccalaureate, professional masters in nursing practice, and PhD programs. The School offers graduate programs in nursing informatics as well as many other advanced nursing degree programs.

BOOTH #18

## University Partnership for Health Informatics (UP-HI)

[www.uphi.umn.edu](http://www.uphi.umn.edu)  
MMC 912, 420 Delaware, St. S.E., Minneapolis, MN 55455  
Contact: Jennifer Trochinski, Program/Operations Mgr  
[troc0021@umn.edu](mailto:troc0021@umn.edu) — 612-626-4132

UP-HI educates new health professionals to assist in the transition from paper to digital – patients' records, prescriptions, best treatments, etc. UP-HI includes the University of Minnesota Twin Cities, College of St. Scholastica and University of Minnesota-Crookston. The consortium will educate in six specialties with the aim of improving the quality, safety, outcomes and value of health services in the U.S.

BOOTH #23

## Wellcentive

[www.wellcentive](http://www.wellcentive)  
2451 Cumberland Parkway, #3668, Atlanta, GA 3033  
Contact: Jim Clifford, Director-Sales and Marketing  
[jjclifford@wellcentive.com](mailto:jjclifford@wellcentive.com) — 877-692-6180 ext. 702

Wellcentive's point-of-care comprehensive Patient Registry/EHR and data exchange systems support PCMH, P4P, CMS, PQRI, Chronic Disease Management, Wellness/Preventive care and other programs. Wellcentive has set new standards for interoperability, reporting, patient outreach and affordability.

BRONZE  
SPONSOR

BRONZE  
SPONSOR

# Planning Committee

Martin LaVenture, PhD, MPH, Co-Chair  
Director, Office of Health Information Technology  
Minnesota Department of Health

Jennifer Lundblad, PhD, MBA, Co-Chair  
President and CEO, Stratis Health

Sally T. Buck, MS  
Associate Director, Rural Health Resource Center

Liz Cinqueonce  
Deputy Director, Office of Health Information Technology  
Minnesota Department of Health

Jennifer Fritz, MPH  
Research Scientist, Minnesota Department of Health

Bob Johnson, MPP  
Project Manager, Minnesota Department of Health

Angie LaFlamme  
Program Coordinator, Rural Health Resource Center

Margaret LeDuc  
CME Coordinator, Stratis Health

Priya Rajamani, MBBS, PhD, MPH  
Senior Project Consultant, Minnesota Department of Health

Anne Schloegel, MPH  
Project Planner, Minnesota Department of Health

Sue Severson  
HIT Services Director, Stratis Health

Donna Watz, JD  
Director of e-Health Privacy and Security Programs  
Minnesota Department of Health

Barbara J. Wills  
Assistant Division Director, Health Policy  
Minnesota Department of Health

Karen Beaulieu  
Conference & Tradeshow Manager, Government Training Services

Helene Johnson  
Executive Director, Government Training Services

Barb Peterson  
Project Leader, Government Training Services

---

ABOUT GOVERNMENT TRAINING SERVICES (GTS)  
GTS staff has provided program/exhibit management, marketing and registration services for this Summit. GTS is a non-profit organization begun in 1976 dedicated to helping those who provide services to Minnesota citizens and communities meet current needs for knowledge and skills and prepare for the changes to come.

# Minnesota e-Health Advisory Committee Members

*Thank you to the Minnesota e-Health Initiative Advisory Committee Members and Workgroup Co-Chairs from 2009-2010 for their leadership and many contributions to the Minnesota e-Health Initiative.*

Walter Cooney  
Executive Director, Neighborhood Health Care Network

Alan Abramson, PhD  
Sr. VP, IS & T and CIO, HealthPartners

Laurie Beyer-Kropuenske, JD  
Director, Information Policy Analysis Division  
Department of Administration

Angie Franks  
Sr. VP of Sales and Market Dev., Healthland

Jennifer Lundblad, PhD  
President and CEO, Stratis Health

Barry Bershow, MD  
VP Quality, Fairview Health Services

RD Brown  
Consumer Advocate

Tim Gallagher  
VP of Pharmacy Operations, Astrup Drug, Inc.

Raymond Gensinger, Jr., MD  
Chief Medical Information Officer, Fairview Health Services

John Gross  
Director, Health Care Policy, Minnesota Department of Commerce

Maureen Ideker  
Associate Administrator,  
Care Management, Rice Memorial Hospital

Julie Jacko, PhD  
Director, The Institute for Health Informatics, University of Minnesota

Paul Kleeberg, MD  
Health Information Technology Consultant

Mary LaVenture, PhD  
Director, Center for Health Informatics,  
Minnesota Department of Health

Bobbie McAdam  
Director, e-Business, Medica

Walter Menning  
Vice Chair, Information Services, Mayo Clinic

Charlie Montreuil  
VP, Enterprise Rewards and Corporate Human Resources, Best Buy

Brian Osberg  
Assistant Commissioner, Minnesota Department of Human Services

David Osborne  
Director of Health Information Technology/Privacy Officer  
Volunteers of America

Cheryl M. Stephens, PhD, MBA  
Executive Director, Community Health Information Collaborative

Joanne Sunquist  
Chief Information Officer, Hennepin County Medical Center

Michael Ubl  
Executive Director, Minnesota Health Information Exchange

Mary Wellik  
Director, Olmstead County Public Health Services

Bonnie Westra, PhD, RN  
Assistant Professor, University of Minnesota, School of Nursing

John Whisney  
Director of Ridgeview Clinics, Ridgeview Medical Center

Tamara Winden  
Healthcare Informatics Consultant

Marty Witrak, PhD, RN  
Professor, Dean, School of Nursing, College of St. Scholastica

## Workgroup Co-Chairs

### Exchange and Meaningful Use Workgroup

Alan Abramson, PhD, *Sr. VP IS&T, CIO, HealthPartners*  
Paul Kleeberg, MD, *Clinical Director, REACH, Stratis Health*

### Minnesota Privacy & Security Workgroup

Laurie Beyer-Kropuenske, *Director, Information Policy Analysis Division, Minnesota Department of Administration*  
Darrell Shreve, *VP of Health Policy, Aging Services of Minnesota*

### Minnesota e-Health Standards & Interoperability Workgroup

Bobbie McAdam, *Director, e-Business, Medica*  
Mike Ubl, *Executive Director, Minnesota Health Information Exchange*

### Outreach and Communications Workgroup

Becky Schierman, *Quality Improvement Manager, Minnesota Medical Association*  
Mark Sonneborn, *VP, Information Services, Minnesota Hospital Association*  
Sue Severson, *Director, Health IT Services, Stratis Health*







# Minnesota e-Health Summit 2010

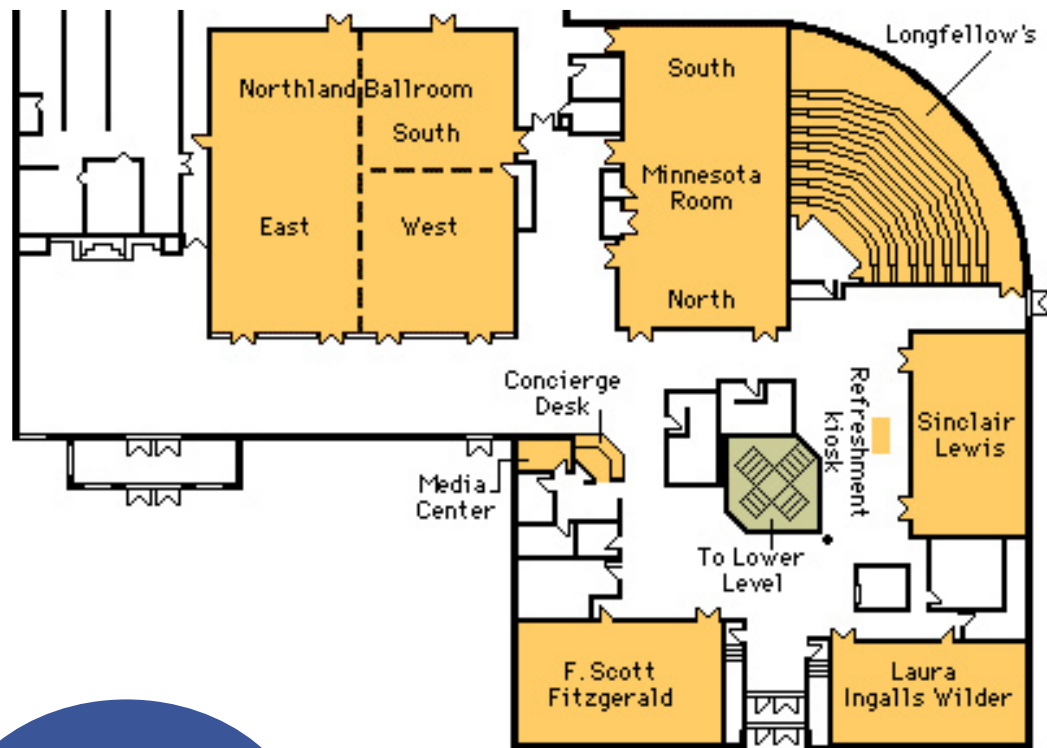

*Northland Inn  
Main Level*