

# Reception Room

- **Good evening!** The meeting will start shortly.
- **Participants are muted** on entry.
- **Check the chat box:** Information about the hearing, including information about how to access captions and view the slides, is available there.
- **To view captions for this event:** You can view captions in Teams by clicking the More (...) button in the Teams window, then “Language and Speech,” and choose "Turn on live captions." You can also view the captions on the web at: <https://www.streamtext.net/player?event=MNDOH&start=0>.
- **If you have any technical issues,** please visit the [Microsoft support page for Teams](#) or email [Health.HRDCommunications@state.mn.us](mailto:Health.HRDCommunications@state.mn.us).

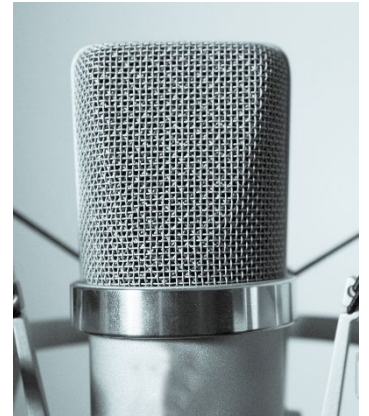



# Mayo New Prague Public Hearing

Cessation of Labor and Delivery Services  
February 6, 2024

PROTECTING, MAINTAINING AND IMPROVING THE HEALTH OF ALL MINNESOTANS

Your moderator for today's hearing:



**Stacy Sjogren (Show-gren)**  
Management Analysis  
and Development  
Senior Consultant

# Tennessean Warning

- **The Minnesota Department of Health is hosting this public hearing to inform the public as required by law.**
- **Your comments, questions, and image, which may be private data, may be visible during this event.** You are not required to provide this data, and there are no consequences for declining to do so.
- **The virtual presentation may be accessible to anyone** who has a business or legal right to access it. By participating, you are authorizing the data collected during this presentation to be maintained by MDH. MDH will be posting a transcript of this meeting to the website.
- **To opt out of the presentation, please exit now.**

6:05 p.m. – Introductions

6:10 p.m. – Welcome from MDH Health Regulation Division Director

6:15 p.m. – Overview

6:20 p.m. – Mayo New Prague Presentation

6:50 p.m. – Public Comments and Questions

7:20 p.m. – Mayo New Prague Closing Remarks

7:25 p.m. – Conclusion

7:30 p.m. – Public Hearing ends

# Introductions



**Maria King,**  
MDH Health  
Regulation Director



**James Hebl, MD**  
Regional Vice  
President, Mayo  
Clinic Health System



**Travis Paul**  
Regional Chair of  
Administration, Mayo  
Clinic Health System



**Lisa McConnell, RN**  
Regional Chief  
Nursing Officer,  
Mayo Clinic Health  
System



**Gokhan Anil, MD**  
Regional Chair of  
Clinical Practice,  
OB-GYN Physician,  
Mayo Clinic Health  
System

# Public Hearing Overview

- **The Minnesota Department of Health serves as a facilitator** to ensure there is public discussion and engagement for any proposed closure, reduction of services or relocation of services for a hospital or hospital campus as outlined in [Minnesota Statutes Sec. 144.555](#).
- **This statute gives MDH the authority to hold the meeting and to inform the public** but not to change, delay or prevent the proposed changes, closures or relocations.



# Mayo New Prague Presentation

**Mayo New Prague will provide information** on the cessation of its labor and delivery services.

- **An explanation by the hospital's representatives of the reasons for ceasing** their labor and delivery services at Mayo Clinic New Prague.
- **A description of the actions that Mayo New Prague will take** to ensure that residents in the hospital's service area have continued access to the health services being modified.



# **MAYO CLINIC HEALTH SYSTEM IN NEW PRAGUE**

## **RELOCATION OF INPATIENT OBSTETRIC SERVICES**

Minnesota Department of Health Public Forum  
February 6, 2024

# LEADERSHIP



**James Hebl, M.D.**  
Regional Vice-President  
Mayo Clinic Health System



**Travis Paul**  
Regional Chair of Administration  
Mayo Clinic Health System



**Lisa McConnell, R.N.**  
Regional Chief Nursing Officer  
Mayo Clinic Health System



**Gokhan Anil, M.D.**  
Regional Chair of Clinical Practice  
OB-GYN Physician  
Mayo Clinic Health System

# AGENDA

- **Overview of Mayo Clinic Health System (MCHS) in New Prague**
- **Summary of inpatient obstetric program changes**
  - ✓ Current state of Labor & Delivery (L&D) practice
  - ✓ Reasons for change:
    1. *Declining birth volumes*
    2. *Recruitment challenges*
  - ✓ Plans for transitioning to a shared model of care
  - ✓ Communication plan to patients and the community
- **Support to patients, staff and community during the transition**
- **Review ongoing investments at MCHS New Prague**

# MCHS New Prague

- Critical Access Hospital
- 19 inpatient beds
- Transitional Care Program
- Emergency Department
- Urgent Care
- Surgical Suites
- Robotic surgery
- Rehabilitation Services and Therapy
- Infusion Therapy Center
- Lab and Radiology
  - ✓ CT, X-ray, MRI, Ultrasound, PET CT, Nuclear Medicine, Bone density, 3D Mammography



Allergy  
Audiology  
Cardiology  
Family Medicine  
General Surgery  
Medical Oncology

Neurology  
Neurosurgery  
OB-GYN  
Orthopedics  
Pediatrics  
Physical Medicine

Podiatry  
Pulmonary Medicine  
Sleep Medicine  
Social Work  
Urology

# New Prague Inpatient Obstetric Practice

- Declining birth volumes over the past several years
- Birth volumes
  - 2019: 122 deliveries
  - 2020: 118 deliveries
  - 2021: 111 deliveries
  - 2022: 92 deliveries
  - 2023: 98 deliveries
- Vaginal births: 70 (2023)
- Approximately 1.2 vaginal births per week
- Volumes represent 1% of births within the service area

-20% ↓



# Declining Volumes: External Factors



## Declining Birth Rate

↓ 21% since 2007



## Future Birth Rate Projections\*

↓ 4% over next 10 years  
(total births)

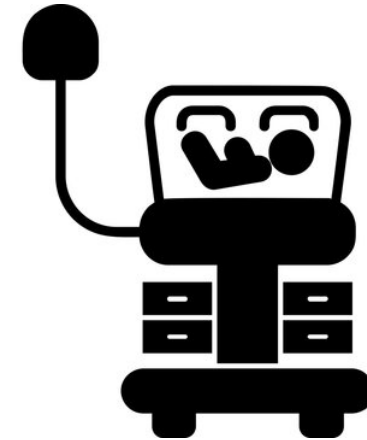

## High-Risk Pregnancies\*

↑ 7% over next 10 years

**Current state:** 35% of pregnancies are considered high-risk

\* *Impact of Change, 2023. Agency for Healthcare Research and Quality.*

# Impact of Low Birth Volumes

- 1. Challenges the ability of staff to maintain experience and skills**
  - Obstetricians and nursing staff concerned with maintaining skills in a low-volume practice
- 2. Difficulty recruiting and retaining staff**
  - Physician and nursing staff often prefer high-volume practices to ensure adequate exposure to clinical experiences



# Nationwide Obstetrician Shortage

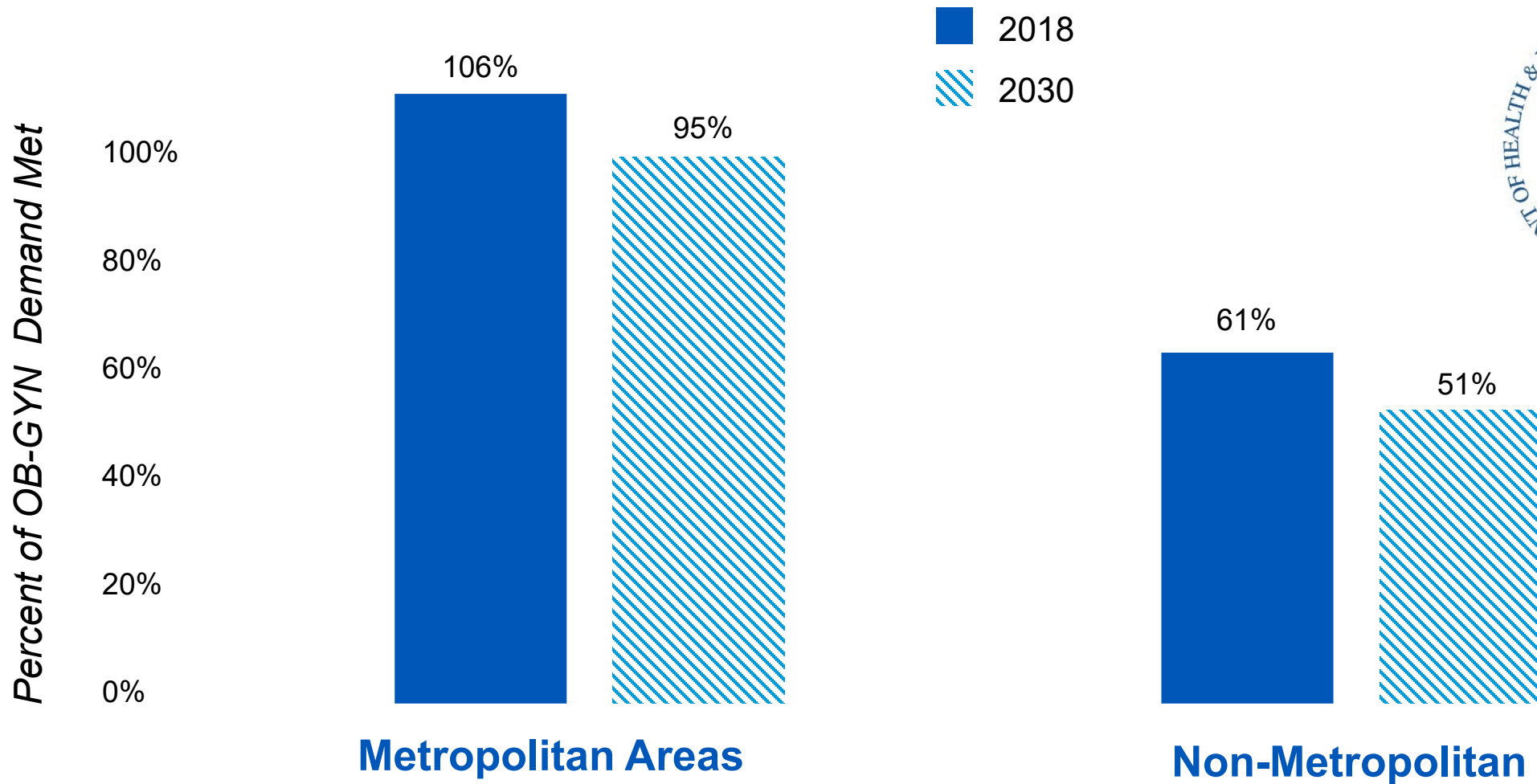



# OB-GYN Recruitment Challenges

- Currently have a single OB-GYN physician in New Prague
- Hiring challenges despite aggressive recruitment efforts for several years
- Intermittent diversions have occurred in the practice due to limited staffing
- Current model is unsustainable given our own expectations for excellence in quality of care



# Transition to a Shared Model of Care

- Effective February 9<sup>th</sup> (5:00 p.m.) the Labor & Delivery Unit in New Prague will close
- OB-GYN services maintained in New Prague:
  - ✓ Prenatal care
  - ✓ Postnatal care
  - ✓ Well-baby care / Pediatrics
  - ✓ GYN medical and surgical care
- Multidisciplinary team of providers
- Inpatient obstetric care will transition seamlessly to MCHS Mankato hospital
- Patient choice of delivery site will remain a priority



# MCHS Mankato

- Regional MCHS hospital
- High-volume Labor & Delivery Unit
- Provide comprehensive obstetric care
  - ✓ OB-GYN physicians
  - ✓ Certified nurse midwives
  - ✓ Anesthesia care team
  - ✓ Inpatient pediatric hospitalists (24/7)
  - ✓ Level II nursery (intensive care for sick & premature infants)
  - ✓ Certified lactation counselors
  - ✓ Partner: Minnesota Milk Bank for Babies
- New state-of-the-art Family Birth Center opening in May (2024)



# Communication Plan

- Comprehensive plan launched over the past 2 weeks
- Minnesota Department of Health (Public hearing)
- The Joint Commission
- Stakeholders already contacted:
  - ✓ Patients (1:1 personal phone calls)
  - ✓ Mayo Clinic Health System Staff
  - ✓ Community leaders
  - ✓ State elected officials
  - ✓ County Departments of Health / Public health
  - ✓ Community education resources
  - ✓ Area hospitals + Outpatient practices
  - ✓ Ambulance transport system
  - ✓ Local media



# Transition Plans

## Commitment to patients, staff and community during the transition

### Patients:

- Actively working with patients on new birth plans
- Accommodations in Mankato
- Facilitating hand-offs to new OB-GYN providers

### Staff:

- 75% of staff have already secured new positions
- Additional training for Emergency Department staff on obstetric scenarios

### Community:

- Working with community education and public health



# Commitment to the Community





**Operating Room Expansion and Modernization Project**



**New Cancer Center Expansion and Modernization Project**



**MAYO CLINIC HEALTH SYSTEM**

**Expanded Patient Services in New Prague**

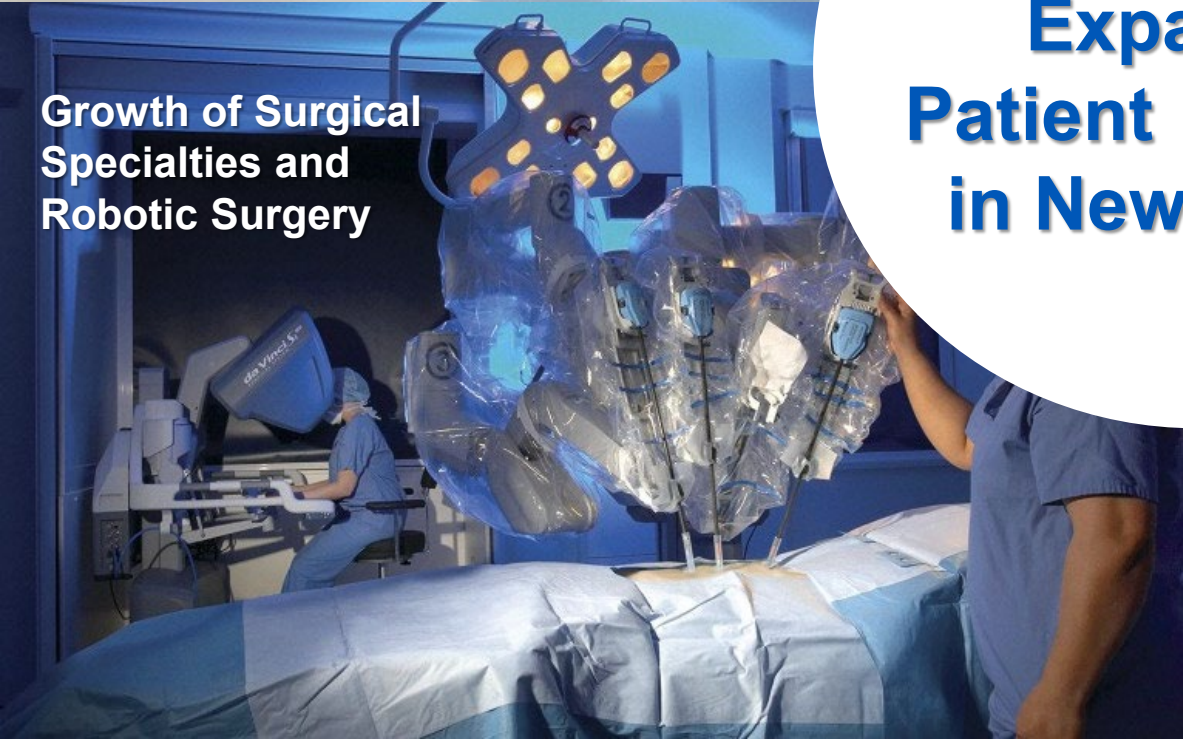

**Growth of Surgical Specialties and Robotic Surgery**



**New Infusion Therapy Center**

# Summary

- Discontinuation of inpatient obstetric care at MCHS New Prague
- Closure of Labor & Delivery Unit effective February 9, 2024 (at 5:00 PM)
- Transition the practice to a shared regional model of care
- Inpatient obstetric care provided at MCHS Mankato
- MCHS New Prague will continue to provide:
  - ✓ Prenatal care
  - ✓ Postnatal care
  - ✓ Well-baby care / Pediatrics
  - ✓ GYN medical and surgical care



- **We welcome your comments and questions.**
- **Each person will have up to three minutes to ask a question or provide public comment.**
- **Please remember that the information you are sharing is being shared virtually for a public forum.**
- **Mayo New Prague will have up to three minutes to respond to each of the questions and/or comments.**

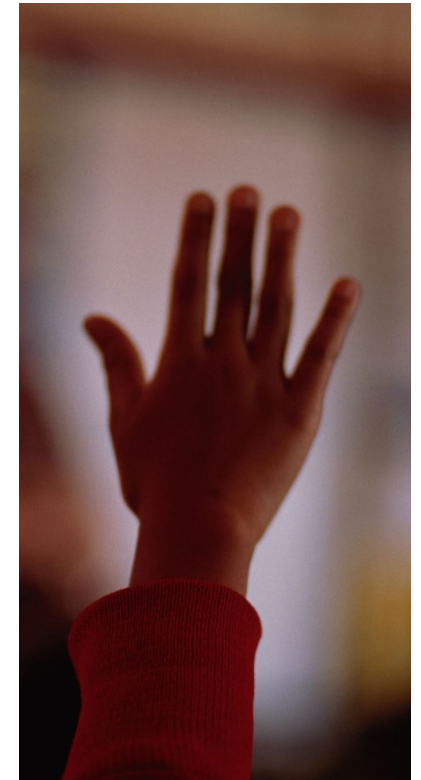

# How to Comment

**Two ways to ask a question** or provide a comment:

1. Raise your hand (outlined in red).
  2. Click the Chat bubble (circled in blue) to open the chat.
- For phone attendees, press **\*5** to raise your hand, and **\*6** to unmute/mute yourself.
  - **We will select speakers** in order and add questions from the chat throughout the public comment period.
  - **Please be respectful.** Abusive, slanderous (comments meant to discredit or malign someone) and vulgar language will not be tolerated.

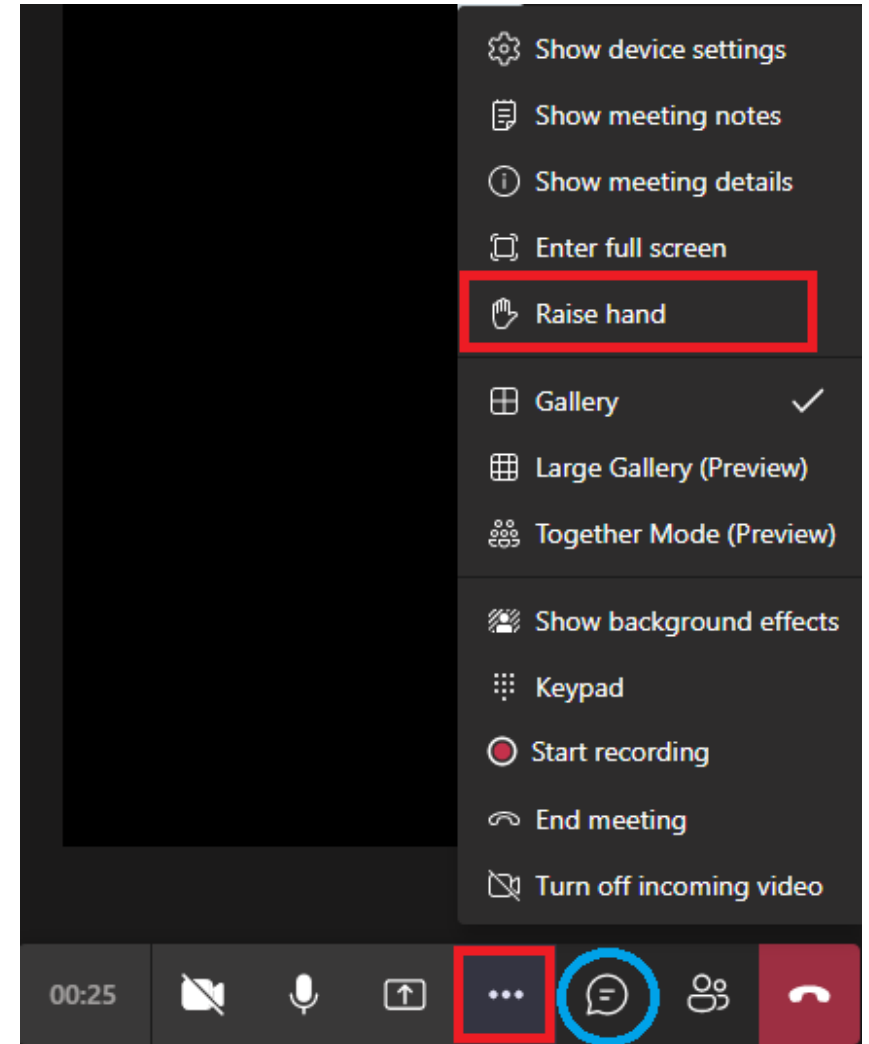

**Last question** with 5 minutes remaining



# Mayo New Prague Closing Remarks



**James Hebl, MD**  
Regional Vice  
President, Mayo  
Clinic Health System



**Travis Paul**  
Regional Chair of  
Administraion, Mayo  
Clinic Health System  
Division Chair of  
Women's and Inpatient  
Children's Services



**Lisa McConnell, RN**  
Regional Chief  
Nursing Officer,  
Mayo Clinic Health  
System



**Gokhan Anil, MD**  
Regional Chair of  
Clinical Practice,  
OB-GYN Physician,  
Mayo Clinic Health  
System

# Conclusion

- Thank you for participating in the Mayo New Prague public hearing.
- The statute ([Minnesota Statutes Sec. 144.55](#)) gives MDH the authority to hold the meeting and to inform the public but not to change, delay or prevent the proposed changes, closures or relocations.
- You may provide comments or feedback on the [hearing website](#).
  - Comments for Mayo New Prague will be accepted until February 7, 2024.
- A transcript of the meeting will be available on the hearing website in 7-10 business days.



**Maria King,**  
MDH Health Regulation Director

# Thank you!

Health Regulation Division Federal Licensing Team

[Health.HRD-FedLCR@state.mn.us](mailto:Health.HRD-FedLCR@state.mn.us)