



# Allina Mercy-Unity Campus and Abbott Northwestern Hospital

Closure of the Inpatient Chemical Dependency Unit at Mercy Hospital – Unity Campus and Kidney Transplant Program at Abbott Northwestern Hospital  
Sept. 25, 2025

PROTECTING, MAINTAINING AND IMPROVING THE HEALTH OF ALL MINNESOTANS

# Online Reception Room

- **Good evening!** The meeting will start shortly.
- **Participants are muted** on entry.
- **Check the chat box:** Information about the hearing, including information about how to access captions and view the slides, is available there.
- **To view captions for this event:** You can view captions in Teams by clicking the More (...) button in the Teams window, then “Language and Speech,” and choose "Turn on live captions." You can also view the captions on the web at: <https://www.streamtext.net/player?event=MNDOH&start=0>.
- **If you have any technical issues,** please visit the [Microsoft support page for Teams](#) or email [Health.HRDCommunications@state.mn.us](mailto:Health.HRDCommunications@state.mn.us).

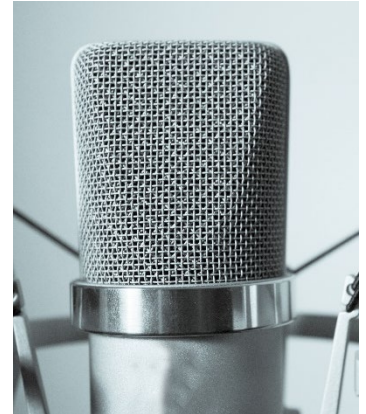

Your moderator for today's hearing:



**Catherine Lloyd**  
Planning and Partnerships  
Manager, MDH

# Tennesen Warning

- **The Minnesota Department of Health is hosting this public hearing to inform the public as required by law.**
- **Your comments, questions, and image, which may be private data, may be visible during this event.** You are not required to provide this data, and there are no consequences for declining to do so.
- **The virtual presentation may be accessible to anyone** who has a business or legal right to access it. By participating, you are authorizing the data collected during this presentation to be maintained by MDH. MDH will be posting a transcript of this meeting to the website.
- **To opt out of the presentation, please exit now.**

- Introductions
- Welcome from MDH Health Regulation Division Director
- Overview
- Allina Mercy-Unity Campus and Abbott Northwestern Hospital presentation
- Public comments and questions
- Allina Mercy-Unity Campus and Abbott Northwestern Hospital closing remarks
- Conclusion

# Introductions



**Maria King**  
Health  
Regulation  
Division Director  
Minnesota  
Department of  
Health



**Michael Johnston**  
President  
Mercy Hospital



**Joe Clubb, MSW,  
LICSW**  
Vice President,  
Mental Health and  
Addiction Services



**Sarah Kaspari,  
DNP, RN**  
Director of  
Advanced Heart  
Failure and  
Transplant  
Services



**Dan O'Laughlin,  
MD, FACEP**  
Vice President,  
Medical Affairs  
and Acute Care  
Clinical Services

# Public Hearing Overview

- **The Minnesota Department of Health serves as a neutral host** to ensure there is public discussion and engagement for any proposed closure, reduction of services or relocation of services for a hospital or hospital campus as outlined in [Minnesota Statutes Sec. 144.555](#).
- This statute gives MDH the authority to host the meeting to ensure the public has an opportunity to hear about the hospital's decision and to have their feedback heard. **MDH does not have the authority to change, delay, or prevent the proposed changes, closures or relocations.**



# Allina Mercy-Unity Campus and Abbott Northwestern Hospital Presentation

- **Allina Health will provide information** of its closure of the inpatient chemical dependency unit at Mercy Hospital – Unity Campus as well as changes to the Kidney Transplant Program at Abbott Northwestern Hospital.
- **An explanation by the hospital's representatives of the reasons for** the inpatient chemical dependency unit at Mercy Hospital – Unity Campus as well as changes to the Kidney Transplant Program at Abbott Northwestern Hospital.
- **A description of the actions that Allina Health will take** to ensure that residents in the hospital's service area have continued access to the health services being modified.



# Mercy Hospital Repositioning

**Michael Johnston**

*President, Mercy Hospital*

**Joe Clubb, MSW, LICSW**

*Vice President, Mental Health and Addiction Services*

**Sarah Kaspari, DNP, RN**

*Director of Advanced Heart Failure and Transplant Services*

**Dan O’Laughlin, MD, FACEP**

*Vice President, Medical Affairs and Acute Care Clinical Services*

September 25, 2025

Allina Health ™

# Today's Agenda

- Who we are
- Gratitude
- Why we're closing the inpatient chemical dependency unit
- Continued excellence in Mental Health and Addiction services
- An update on our Kidney Transplant Program
- Commitment to our teams



Allina Health 

## WHO WE ARE



Allina Health is a nonprofit health system that cares for individuals, families and communities throughout Minnesota and western Wisconsin.

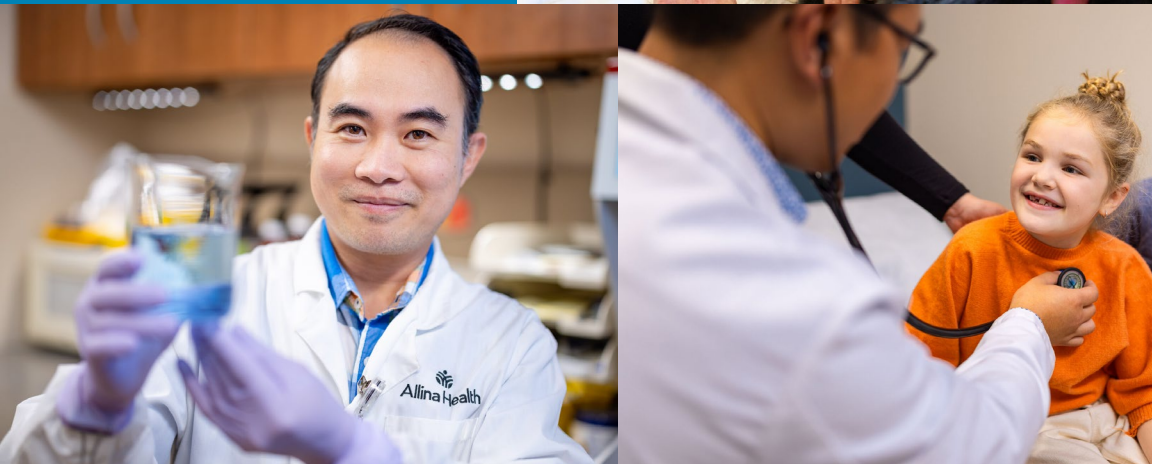



**27,865**

CARE TEAM MEMBERS  
(EMPLOYEES)



**82,000**

SURGICAL  
PROCEDURES



**1.3m**

RETAIL  
PRESCRIPTIONS

**6.6m**

CLINIC & URGENT  
CARE VISITS



**547,355**

HEALTH-RELATED  
SOCIAL NEEDS  
SCREENINGS



**1.4m**

HOSPITAL VISITS

**304,100**

ED VISITS



**\$434.8m**

DISTRIBUTED THROUGH  
COMMUNITY BENEFIT  
PROGRAMS

**3,445**

VOLUNTEERS



**12,050**

BIRTHS

**670**

ACTIVE RESEARCH STUDIES



**148,800**

AMBULANCE RESPONSES

**6,700**

EXPERT PROVIDERS





# Mercy Hospital - Unity Campus Fast Facts

- 71 Inpatient beds for adults and seniors.
- The campus includes:
  - Emergency Department staffed 24/7 with Mental Health Crisis Clinicians and E.D Psychiatry
  - Center for Mental Health and Addiction
  - Adult/Senior Intensive Outpatient Addiction services
  - Scheduled and walk-in chemical dependency evaluations
  - Virtual addiction clinic serving Minnesota and Western Wisconsin.
  - Hospital-Based Clinic serving children, adolescents, adults and seniors
  - Partial Hospital and Day Treatment.







# Gratitude

Allina Health and Mercy Hospital are proud to serve a critical role for our communities.

The inpatient chemical dependency unit at Mercy Hospital - Unity Campus was a pioneering unit that has made a profound impact on countless people over the years.

We are grateful for all who have provided care and supported that care.



# Why the inpatient chemical dependency unit is closing

- Advances in addiction medicine now allow many patients to access these services on an outpatient basis or through general admission.
- This has led to fewer patients in the specialized unit.



# Continued access to Mental Health and Addiction Services

- Patients can continue to get the addiction care they need in an outpatient setting at several locations, including the Center for Mental Health and Addiction Care on the Unity Campus and virtually.
- We are expanding access to outpatient addiction services at additional locations in 2026.

Services	Locations
Outpatient addiction services	<ul style="list-style-type: none"><li>• Center for Mental Health and Addiction Care (Unity Campus)</li><li>• United Hospital – Hastings Regina Campus</li><li>• Cambridge Medical Center</li><li>• Virtual</li></ul>
Medical Detox	<ul style="list-style-type: none"><li>• Available through general admission.</li></ul>



# Update on our Kidney Transplant Program

- The Kidney Transplant and Living Kidney Donor Program has operated at Abbott Northwestern Hospital for 28 years
- The program has cared for patients in need of a new kidney from the moment they join the waiting list through recovery, including lifelong post-transplant care. The program has also cared for living kidney donors.
- As of June 27, 2025, we no longer perform kidney transplants.



# Update on our Kidney Transplant Program

- **Why?** We made this decision after careful consideration of our ability to fully staff the program.
- **What's NOT changing?**
  - Patients have not lost accumulated waiting time. Current wait times are preserved and can be transferred once they are approved by another kidney transplant center.
  - Eligible patients are still on the national kidney transplant waitlist.
- **Continued care for transplant patients**
  - We continue to care for patients who have had a kidney transplant.
  - We are working closely with patients who were awaiting transplant to transfer their records to another program.

# Commitment to our teams

- We are committed to working with care team members on a 1:1 basis, as well as following the process outlined with their union representatives to identify open positions if they are interested.



Allina Health

# Thank you

- **We welcome your comments and questions.**
- **Each person will have up to three minutes to ask a question or provide public comment.**
- **Please remember that the information you are sharing is being shared virtually for a public forum.**
- **Allina Health will have an opportunity to respond to the questions and/or comments.**

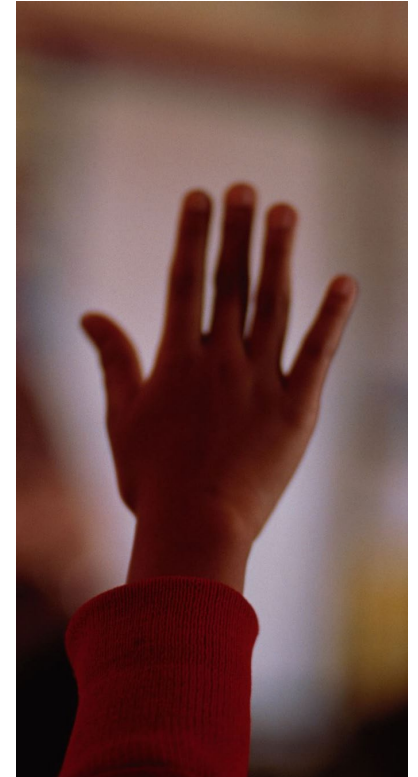

# How to Comment

**Two ways to ask a question or provide a comment:**

1. Raise your hand (outlined in red).
  2. Click the Chat bubble (circled in blue) to open the chat.
- For phone attendees, press **\*5** to raise your hand, and **\*6** to unmute/mute yourself.
  - **We will select speakers** in order and add questions from the chat throughout the public comment period.
  - **Please be respectful.** Abusive, slanderous (comments meant to discredit or malign someone) and vulgar language will not be tolerated.

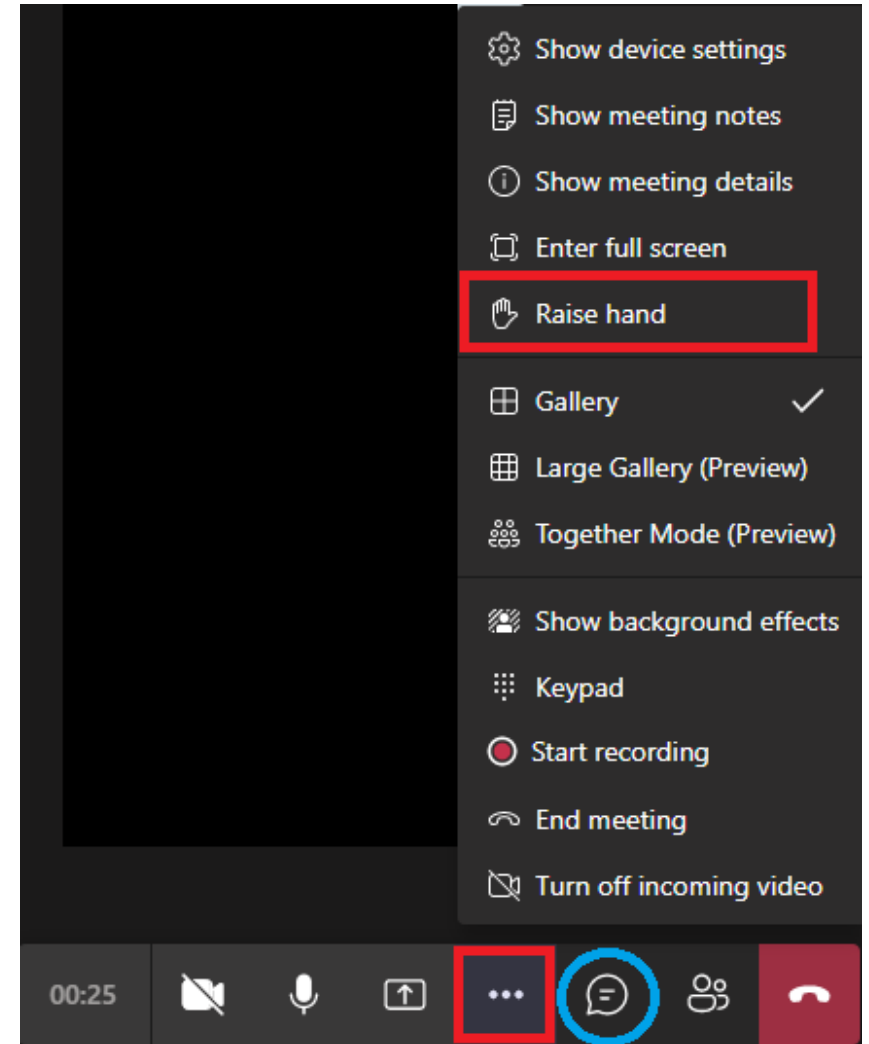

# Allina Mercy-Unity Campus and Abbott Northwestern Hospital Closing Remarks



**Maria King**  
Health  
Regulation  
Division Director  
Minnesota  
Department of  
Health



**Michael Johnston**  
President  
Mercy Hospital



**Joe Clubb, MSW,  
LICSW**  
Vice President,  
Mental Health and  
Addiction Services



**Sarah Kaspari,  
DNP, RN**  
Director of  
Advanced Heart  
Failure and  
Transplant  
Services



**Dan O'Laughlin,  
MD, FACEP**  
Vice President,  
Medical Affairs  
and Acute Care  
Clinical Services



# Conclusion

- Thank you for participating in the Allina Mercy-Unity Campus and Abbott Northwestern Hospital public hearing.
- Statute [Minnesota Statutes Sec. 144.555](#) gives MDH the authority to host the meeting to ensure the public has an opportunity to hear about the hospital's decision and to have their feedback heard. **MDH does not have the authority to change, delay, or prevent the proposed changes, closures or relocations.**
- You may provide comments or feedback on the [hearing website](#).
  - Comments for Allina Mercy-Unity Campus and Abbott Northwestern Hospital will be accepted until 11:59 p.m. on Sept. 26, 2025.
- A transcript of the meeting will be available on the hearing website in 10 business days.



**Maria King**  
Health Regulation Division  
Director  
Minnesota Department of  
Health



# Thank you!

Health Regulation Division Federal Licensing Team

[Health.HRD-FedLCR@state.mn.us](mailto:Health.HRD-FedLCR@state.mn.us)